

## Straight Coupling Copper x female iron

### GENERAL INFORMATION

Pattern No. key :DR = DZR Brass, CP = Chrome Plate

Size	Pattern No.	Box Qty	Code	Barcode	Price (£) ex VAT
15mmx1/2	DR41	5	770007	5013866021879	£4.97
22mmx3/4	DR41	5	770008	5013866021886	£7.80
22mmx1	DR41	5	770018	5013866021893	£15.64
28mmx1	DR41	5	770019	5013866021909	£15.11
35mmx1 1/4	DR41	1	770020	5013866021916	£32.40
42mmx1 1/2	DR41	1	770021	5013866021923	£45.49
54mmx2	DR41	1	770022	5013866021930	£66.42

### DIMENSIONS (mm)

Code	Description	A
770007	15MMX1/2 GM41 GUNMETAL STRT CPLNG CXF	37
770008	22MMX3/4 GM41 GUNMETAL STRT CPLNG CXF	43
770018	22MMX1 GM41 GUNMETAL STRT CPLNG CXF	44
770019	28MMX1 GM41 GUNMETAL STRT CPLNG CXF	44
770020	35MMX1.1/4 GM41 GUNMETAL STRT CPLNG CXF	50
770021	42MMX1.1/2 GM41 GUNMETAL STRT CPLNG CXF	54
770022	54MMX2 GM41 GUNMETAL STRAIGHT CPLNG CXF	61

### MATERIAL SPECIFICATIONS

Number	Component	Material
1	Body	Brass Bar (8-28mm) Forged Brass (35-54mm)
2	Capnut	Forged Brass
3	Cone	Brass

### SPARES

#### DR41 - Size - 15mmx1/2

Spare Key	Description	Code	Barcode	Date From	Date To	Price (£) ex VAT
1	15MM 105 PRESTEX TYPE A BRASS CAPNUT	860097	5013866023774	All variations		£2.11
2	15MM C103 COPPER CONE	860007	5013866023514	May 01 1999	To Current	£1.02
2	15MM 103 BRASS CONE	860047	5013866023637	All variations		£1.02

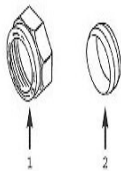

#### DR41 - Size - 22mmx3/4

Spare Key	Description	Code	Barcode	Date From	Date To	Price (£) ex VAT
1	22MM 105 PRESTEX TYPE A BRASS CAPNUT	860068	5013866023729	All variations		£3.61
2	22MM 103 BRASS CONE	860048	5013866023644	All variations		£1.37
2	22MM C103 COPPER CONE	860008	5013866023521	May 01 1999	To Current	£1.37

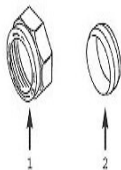

**DR41 - Size - 22mmx1**

Spare Key	Description	Code	Barcode	Date From	Date To	Price (£) ex VAT
1	22MM 105 PRESTEX TYPE A BRASS CAPNUT	860068	5013866023729	All variations		£3.61
2	22MM C103 COPPER CONE	860008	5013866023521	May 01 1999	To Current	£1.37
2	22MM 103 BRASS CONE	860048	5013866023644	All variations		£1.37

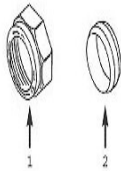

**DR41 - Size - 28mmx1**

Spare Key	Description	Code	Barcode	Date From	Date To	Price (£) ex VAT
1	28MM 105 PRESTEX TYPE A BRASS CAPNUT	860069	5013866023736	All variations		£4.92
2	28MM 103 BRASS CONE	860309	5013866024085	All variations		£1.80
2	28MM C103 COPPER CONE	860009	5013866023538	May 01 1999	To Current	£1.80

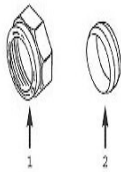

**DR41 - Size - 35mmx1.1/4**

Spare Key	Description	Code	Barcode	Date From	Date To	Price (£) ex VAT
1	35MM 105 PRESTEX TYPE A BRASS CAPNUT	860070	5013866023743	All variations		£6.79
2	35MM 103 BRASS CONE	860050	5013866023651	All variations		£2.66
2	35MM C103 COPPER CONE	860010	5013866023545	May 01 1999	To Current	£2.75

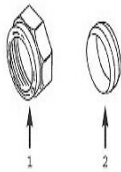

**DR41 - Size - 42mmx1.1/2**

Spare Key	Description	Code	Barcode	Date From	Date To	Price (£) ex VAT
1	42MM 105 PRESTEX TYPE A BRASS CAPNUT	860071	5013866023750	All variations		£10.08
2	42MM C103 COPPER CONE	860011	5013866023552	May 01 1999	To Current	£5.11
2	42MM 103 BRASS CONE	860051	5013866023668	All variations		£5.11

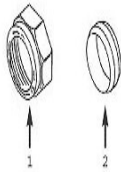

**DR41 - Size - 54mmx2**

Spare Key	Description	Code	Barcode	Date From	Date To	Price (£) ex VAT
1	54MM 105 PRESTEX TYPE A BRASS CAPNUT	860072	5013866023767	All variations		£17.49
2	54MM C103 COPPER CONE	860012	5013866023569	May 01 1999	To Current	£8.22
2	54MM 103 BRASS CONE	860052	5013866023675	All variations		£8.22

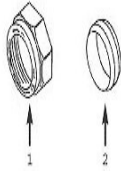
**CARE & MAINTENANCE****Care**

This product does not require any regular aesthetic care.

**Maintenance**

No maintenance is required for this product; if possible a visual inspection can be undertaken for any accidental knocks. Do not attempt to over tighten as this will not produce a better joint.

For any further maintenance issues please contact your local qualified installer.

If your product is under warranty please contact the Service Support Team on: 0800 1560050.

**REGULATIONS****Regulations**

It is important to ensure that the water supplies to your waste are connected in accordance with the water regulations (WRAS) requirements and good plumbing practice. This product complies to EN1254 and the kitemark standard and is documented in the WRAS Water fittings directory.

**GUARANTEE****Valves and Fittings****Pegler Yorkshire Customcare 5 Year Guarantee - Terms and Conditions**

Products are subject to a 5 year guarantee that is between Pegler Yorkshire and the final purchaser of the product.

The guarantee is subject to proof of purchase being supplied.

This guarantee does not affect any statutory rights the consumer may have in law.

The guarantee covers manufacturing or material defects and does not cover parts subject to normal wear and tear.

This product range has been designed for the use of homeowners, domestic and commercial applications and therefore the guarantee is subject to the product being properly selected for their intended service conditions.

The guarantee is not applicable where the product is fitted contrary to the conditions in the fitting instructions.

This is reinforced where valves are covered by the European Pressure Equipment Directive (PED97/23/EC) where Installation, Operating and Maintenance Instructions are supplied with each product and/or carton.

Provided it is installed correctly and receives adequate preventative maintenance it should give years of trouble – free service.

Abusive behaviour and accidental damage to the product are not covered by this guarantee.

The extent of this liability is limited to the cost of the replacement of the defective item and not to fitting or consequential damages.