

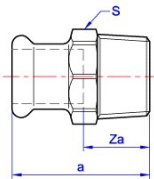

Straight male connector. press-fit x BSP taper male thread.

GENERAL INFORMATION

Size	Pattern No.	Box Qty	Code	Barcode	Price (£) ex VAT
12mm x 3/8"	S3/6243G	5	38105	5022050199386	£7.74
12mm x 1/2"	S3/6243G	5	38106	5022050199546	£7.83
15mm x 3/8"	S3/6243G	5	38107	5022050199706	£8.02
15mm x 1/2"	S3/6243G	10	38114	5022050381149	£6.73
15mm x 3/4"	S3/6243G	5	38115	5022050199812	£8.02
18mm x 1/2"	S3/6243G	5	38108	5022050199973	£10.37
18mm x 3/4"	S3/6243G	5	38109	5022050200211	£12.60
22mm x 1/2"	S3/6243G	5	38110	5022050200501	£11.28
22mm x 3/4"	S3/6243G	10	38116	5022050381163	£10.16
28mm x 3/4"	S3/6243G	5	38111	5022050200983	£16.20
22mm x 1"	S3/6243G	5	38117	5022050200778	£11.09
28mm x 1"	S3/6243G	5	38118	5022050381187	£13.60
28mm x 1 1/4"	S3/6243G	5	38127	5022050201164	£17.76
35mm x 1"	S3/6243G	5	38112	5022050201324	£24.60
35mm x 1 1/4"	S3/6243G	5	38119	5022050381194	£24.60
42mm x 1 1/4"	S3/6243G	1	38113	5022050201485	£34.86
42mm x 1 1/2"	S3/6243G	1	38120	5022050381200	£32.97
54mm x 2"	S3/6243G	1	38121	5022050381217	£63.63
67mm x 2 1/2"	S3/6243G	1	38122	5022050381224	£122.21
76mm x 2 1/2"	S3/6243G	1	38126	5022050192141	£207.62
76mm x 3"	S3/6243G	1	38123	5022050381231	£211.51
108mm x 4"	S3/6243G	1	38124	5022050381248	£366.20



DIMENSIONS (mm)

Code	Description	a	s	za
38107	15mm x 3/8" S3/6243G	33	21	13
38114	15mm x 1/2" S3/6243G	37	21	17
38115	15mm x 3/4" S3/6243G	39	25	19
38108	18mm x 1/2" S3/6243G	37	25	17
38109	18mm x 3/4" S3/6243G	39	25	19
38110	22mm x 1/2" S3/6243G	38	30	17
38116	22mm x 3/4" S3/6243G	40	30	21
38111	28mm x 3/4" S3/6243G	43	36	20
38117	22mm x 1" S3/6243G	42	32	21
38118	28mm x 1" S3/6243G	44	36	21
38127	28mm x 1.1/4" S3/6243G	48	40	25
38112	35mm x 1" S3/6243G	48	41	22
38119	35mm x 1 1/4" S3/6243G	50	41	24
38113	42mm x 1.1/4" S3/6243G	58	51	28
38120	42mm x 1 1/2" S3/6243G	58	51	28
38121	54mm x 2" S3/6243G	63	63	28
38122	67mm x 2 1/2" S3/6243G	93	80	50
38126	76mm x 2.1/2" S3/6243G	99	84	44
38123	76mm x 3" S3/6243G	110	94	59
38124	108mm x 4" S3/6243G	132	117	50

PRESSURE & TEMPERATURE

XPress Copper performance when correctly assembled with copper tube to BS EN 1057 R250 and R290*‡

XPress Fitting	Tube/pipe used with	Min temperature and pressure	Max temperature and pressure
XPress Copper	Copper	-24 °C at 16bar	110 °C at 16bar

*XPress Copper fittings are not suitable for use with soft copper tube (R220).

‡Hydraulic test pressures must not exceed 16 bar.

GUARANTEE

Pegler Yorkshire XPress Copper, Gas, Stainless and Solar fittings Guarantee - Terms and Conditions

Products are subject to a guarantee that is between Pegler Yorkshire and the final purchaser of the product. When correctly assembled with the stated tubes and pipe the length of guarantee is as follows:

25 Years

The Xpress Copper, Gas, Stainless and Solar ranges are guaranteed for 25 years when installed along with other manufacturers' pipeline components conforming to the specified standard.

30 Years

Where pipelines are constructed exclusively from compatible XPress Copper, Gas, Stainless and Solar fittings and tubes, the resulting installations will be deemed XPress Systems and qualify for a 30 year guarantee.

Qualifying systems are:

- Xpress Copper fittings and Yorkex* copper tube
- Xpress Gas fittings and Yorkex* copper tube
- Xpress Stainless fittings and stainless steel 316 System tube
- Xpress Solar fittings and Kuterlon* copper tube

* Yorkex and Kuterlon are brand names of Yorkshire Copper Tube/KME Group

The guarantee is subject to proof of purchase being supplied.

This guarantee does not affect any statutory rights the consumer may have in law.

The guarantee covers manufacturing or material defects when installed in accordance with our instructions on specified tube materials and applications, and does not cover parts subject to normal wear and tear.

This product range has been designed for the use of homeowners, domestic and commercial applications and therefore the Guarantee is subject to the product being properly selected for their intended service conditions.

The guarantee is not applicable where the product is fitted contrary to the conditions in the fitting instructions.

This is reinforced where valves are covered by the European Pressure Equipment Directive (PED97/23/EC) where Installation, Operating and Maintenance Instructions are supplied with each product and/or carton.

Provided it is installed correctly and receives adequate preventative maintenance it should give years of trouble-free service.

Abusive behaviour and accidental damage to the product are not covered by this guarantee.

The extent of this liability is limited to the cost of the replacement of the defective item and not to installation or consequential damages.

APPROVALS



[CSN](#)



[ATG](#)

Byggeforsk

[BYGGFORSK](#)

Cobrti

[Cobrti](#)



[CSTB](#)

DNV

[DNV](#)



[DVGW](#)



[ÉMI](#)



[ETA](#)



10 to 54mm
[GLLOYDS_10-54MM](#)



60 to 108mm
[GLLOYDS_60-108MM](#)

kiwa

[KIWA](#)



[Russia](#)

SITAC

[SITAC](#)

STF

[STF](#)

WRAS
APPROVED
PRODUCT

[WRAS](#)