

Male adaptor. male copper for insertion into fitting x BSP taper male thread.

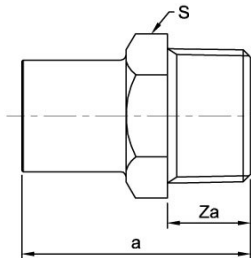

## GENERAL INFORMATION

Size	Pattern No.	Box Qty	Code	Barcode	Price (£) ex VAT
15mm x 1/2"	N8DW	25	88330DW	5022050883360	£18.89
22mm x 3/4"	N8DW	25	88331DW	5022050883377	£25.75



## DIMENSIONS (mm)

Code	Description	a	Za	S
88330DW	15mm x 1/2" N8DW	37	15	24
88331DW	22mm x 3/4" N8DW	40	16	25

## PRESSURE & TEMPERATURE

Endex (and Endbraze 67mm) performance when correctly assembled with copper tube to BS EN 1057 using tin/copper soft solder BS EN 29453 S-Sn99Cu1 or tin/silver soft solder BS EN 29453 L-SnAg5 DIN 1707

Service temperature

Size	-40° C (Min)	30° C	65° C	110° C (Max)
6mm to 28mm	25bar	25bar	25bar	16bar
35mm to 54mm	25bar	25bar	16bar	10bar
67mm	16bar	16bar	16bar	10bar

Endex (and Endbraze 67mm) performance when correctly assembled with copper tube to BS EN 1057 using tin/lead soft solder BS EN 29453 D-Pb60Sn40

Not suitable for use in potable water systems

Service temperature

Size	-15° C (Min)	30° C	65° C	110° C (Max)
6mm to 54mm	16bar	16bar	10bar	6bar
67mm	10bar	10bar	6bar	4bar

## GUARANTEE

### Pegler Yorkshire 25 Year Guarantee - Terms and Conditions

Products are subject to a 25 year guarantee that is between Pegler Yorkshire and the final purchaser of the product.

The guarantee is subject to proof of purchase being supplied.

This guarantee does not affect any statutory rights the consumer may have in law.

The guarantee covers manufacturing or material defects when installed in accordance with our instructions on specified tube materials and applications, and does not cover parts subject to normal wear and tear.

This product range has been designed for the use of homeowners, domestic and commercial applications and therefore the Guarantee is subject to the product being properly selected for their intended service conditions.

The guarantee is not applicable where the product is fitted contrary to the conditions in the fitting instructions.

This is reinforced where valves are covered by the European Pressure Equipment Directive (PED97/23/EC) where Installation, Operating and Maintenance Instructions are supplied with each product and/or carton.

Provided it is installed correctly and receives adequate preventative maintenance it should give years of trouble-free service.

Abusive behaviour and accidental damage to the product are not covered by this guarantee.

The extent of this liability is limited to the cost of the replacement of the defective item and not to installation or consequential damages.

## APPROVALS



[DVGW](#)



[BSI](#)



[Russia](#)



[KIWA\\_Gastec](#)



[WRAS](#)



[KIWA](#)