

Instructions

VZL 2, VZL 3, VZL 4

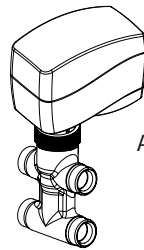

VZL 2



AMV(E) 130, 140

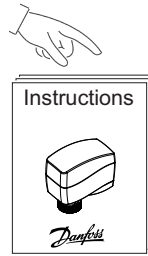

VZL 3

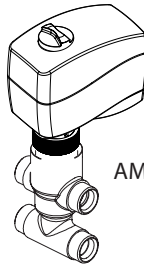

AMV(E) 130H, 140H

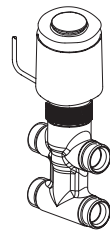
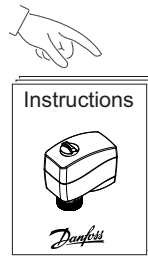

TWA-Z

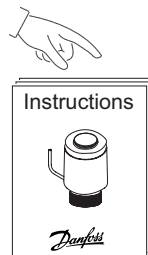

VZL 4

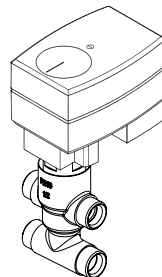

AMV(E) 13 SU

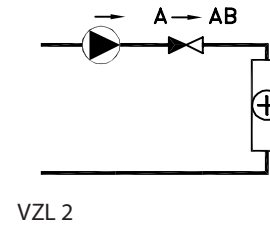

VZL 2

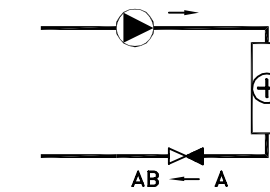

VZL 2

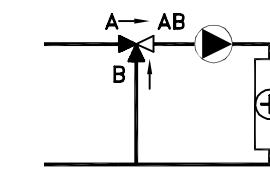

VZL 3/VZL 4

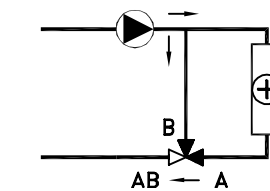

VZL 3/VZL 4

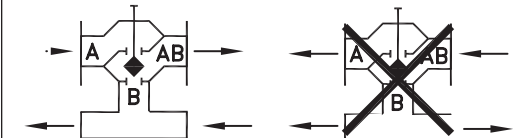
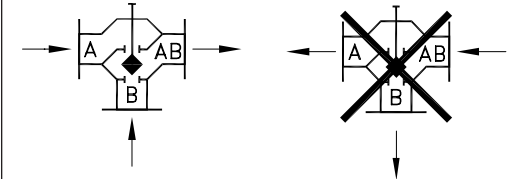
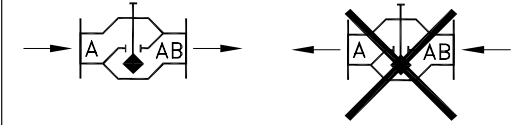

max. t: 120°C
min. t: 2°C

max. P: 16bar

16 bar = 1600 kPa = 232 psi

AMV(E) 130, 140 + VZL
AMV(E) 130H, 140H + VZL

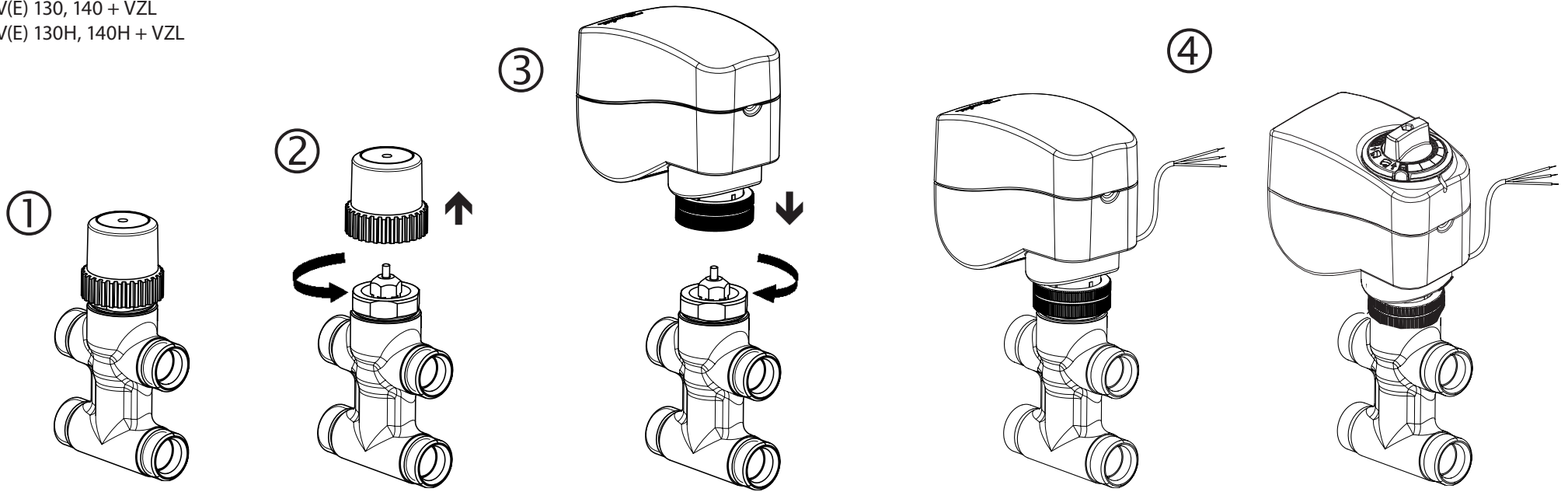

TWA-Z + VZL

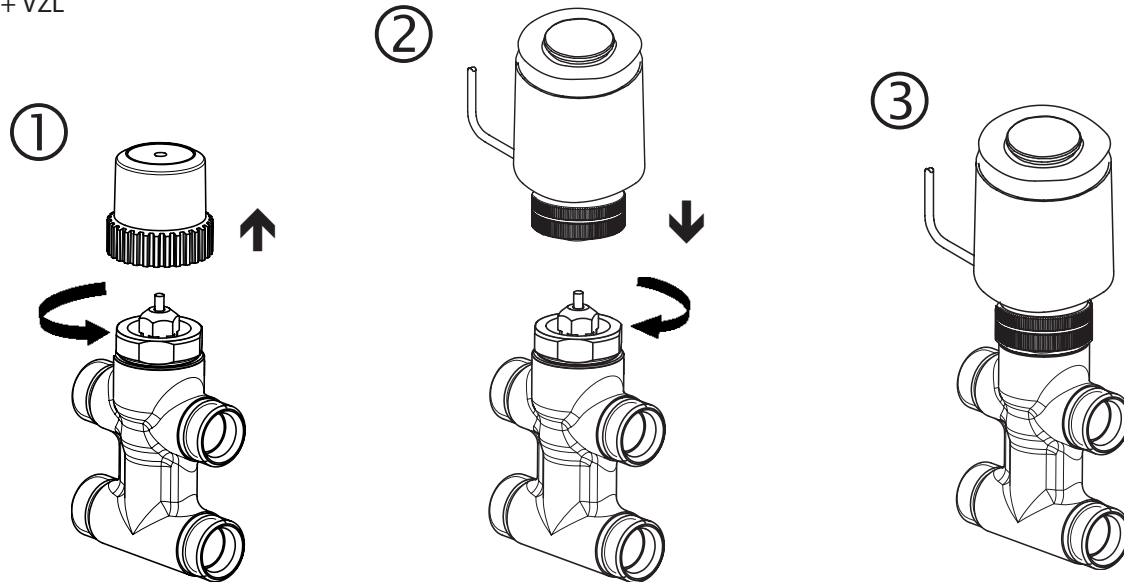

AMV(E) 13 SU + VZL

