

sinks

domestic, commercial,
laboratory and fittings



*Armitage
Shanks*
*Ideal
Standard*

selection
sinks

	Page	Applications	Material	Type	High back	Length	Projection	Depth
Alder cleaners sink	12:2:1		Fireclay	Cleaners	Yes – 30.5cm	51cm	38cm	23cm
Angus stainless steel cleaners sink	12:2:2		Stainless steel	Cleaners	Yes – 25cm	41cm	34cm	24cm
Belfast contract	12:2:3		Fireclay	Contract	No	46, 61 or 76cm	38 or 46cm	21 or 26cm
Belfast traditional	12:1:1		Fireclay	Domestic	No	60cm	46cm	26cm
Birch laboratory/cleaners	12:2:4		Fireclay	Lab/Cleaners	Yes – 15cm	46 or 51cm	38cm	21 or 23cm
Calder Trough	12:2:5		Stainless steel	Contract	No	120, 180 or 240cm	37cm	15cm
Calder Upstand Trough	12:2:6		Stainless steel	Contract	Yes – 7.7cm	120, 180 or 240cm	39cm	15cm
Edinburgh 60	12:1:2		Fireclay	Domestic	No	60cm	47cm	22cm
Elm plaster receiver	12:2:7		Fireclay	Receiver	No	33cm	33cm	33cm
Havana 11/2 bowl	12:1:3		Fireclay	Domestic	No	98cm	50cm	20cm
Havana single bowl	12:1:3		Fireclay	Domestic	No	98cm	50cm	20cm
Larch laboratory	12:3:1		Fireclay	Laboratory	No	33, 36, 46 or 59cm	28, 33, 36 or 38cm	15, 18, 19 or 23cm
London traditional	12:1:4		Fireclay	Domestic	No	60cm	46cm	26cm
Wansbeck shelf sink	12:2:8		Fireclay	Contract	No	61cm	54cm	26cm

sinks

selection

sinks

domestic



sinks

domestic

*Armitage
Shanks*

*Ideal
Standard*

sinks

Belfast traditional

The traditional Belfast sink is manufactured from heavy duty fireclay. Its ultimate durability makes it perfect for everyday kitchen use.

Its resistance to acids, alkalis and staining means it maintains its appearance and surface for a long time.

- Traditional sink
- Domestic applications
- Resistant to acids and alkalis
- Hard wearing and durable
- Fireclay



Illustrated

S5803 (35003DM)
Belfast sink 60cm x 46cm x 26cm
S8725 (70038P2)
1 1/2in strainer waste, slotted tail
S9219 (7931VE0)
aluminium alloy build-in brackets

Material

Heavy duty fireclay

Weight

49.0kg

Colours

Available in White only

Options

S8768 (70668M0) 1 1/2in chain waste with slotted tail and wood screw stay

sinks
domestic

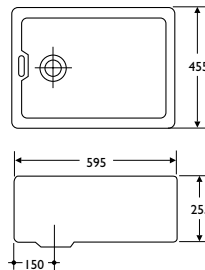

Armitage Shanks

Product information
Tel: 0870 122 8822 Fax: 0870 122 8282
eMail: info@thebluebook.co.uk
www.thebluebook.co.uk

12:1:1

CI/SIB (74) May 2002
Uniclass L721

Ideal Standard

sinks

edinburgh 60

Domestic bow fronted sink in fireclay.

Fireclay's resistance to acids, alkalis and staining means it maintains its appearance and surface for a long time. This durability means that Edinburgh sinks are perfect for everyday kitchen use.

- Fireclay
- Hard wearing and durable
- Domestic applications
- For open front kitchen units

sinks

domestic



Illustrated

S5875 (3544100)
Edinburgh sink
60cm x 51cm x 22cm,
no overflow, centre
back outlet
E0206 Academy sink
monoblock mixer with
swivel nozzle
S9219 (7931VE0)
aluminium alloy
build-in brackets

Material

Fireclay

Weight

Sink 34.4kg

Colours

Available in White only

Special notes

Suitable for waste
disposal or basket
strainer wastes only

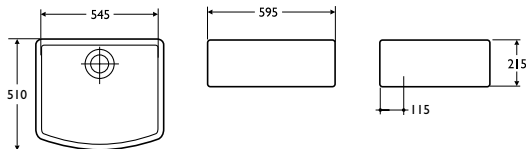

sinks
havana

Sink in fireclay for domestic applications. This 98cm x 50cm countertop sink is fully reversible to suit customer requirements.

- Fireclay
- Hard wearing and durable
- Domestic applications
- Reversible
- Single and 1 1/2 bowl options



Illustrated

S5822 (3541100)
Havana countertop sink with small bowl for vegetable preparation
E6816AA Tantadisc CD monoblock twin flow swivel spout kitchen mixer, chrome plated
S8797 (90358Q8)
combined pop-up waste, and basket strainer with trap, 75mm seal

Material

Fireclay

Weight

Sink (single) 37.6kg
Sink (1 1/2) 34.4kg

Colours

Available in White or Dark Green

Options

S8798 (90368Q8)
combined waste and basket strainer waste with trap, 75mm seal, lift out plug and chrome plated taphole stopper (for 1 1/2 bowl)
S5823 (3540100)
Havana single bowl countertop sink
S8795 (90338Q8)
1 1/2in pop-up waste with trap – 75mm seal (for single bowl)
S8796 (90348Q8)
1 1/2in waste with trap, 75mm seal, lift plug and chrome plated taphole stopper (for single bowl)
S582490 (3538100DP)
Havana single bowl sink in Dark Green
S582690 (3539100DP)
Havana sink with small bowl in Dark Green

Special notes

It is not possible to use Havana sink with a drawer unit

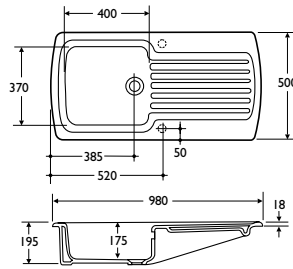
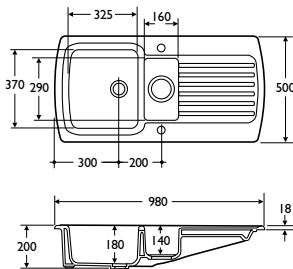

sinks
domestic

sinks

london traditional

The traditional London sink is manufactured from heavy duty fireclay to an exceptional finish for domestic applications.

Its durability makes it perfect for everyday kitchen use. Being resistant to acids, alkalis and staining it maintains its appearance and surface for a long time.

- Traditional design
- Resistant to acids and alkalis
- Very durable
- Domestic applications

sinks

domestic



Illustrated

S5804 (35003WD)
London sink 60cm x
46cm x 26cm
S9219 (7931VE0)
aluminium alloy
build-in brackets

Material

Fireclay

Weight

Sink 49.0kg

Colours

Available in White only

Special notes

Suitable for waste disposal units or basket strainer wastes only

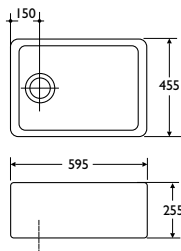

Armitage
Shanks

Product information
Tel: 0870 122 8822 Fax: 0870 122 8282
eMail: info@thebluebook.co.uk
www.thebluebook.co.uk

12 : 1 : 4

CI/SIB (74) May 2002
Uniclass L721

Ideal
Standard

sinks

commercial



sinks

commercial

sinks

commercial

*Armitage
Shanks*

*Ideal
Standard*

sinks
alder

Heavy duty cleaners' sink in fireclay, 51cm x 38cm with 31cm high splashback, bucket grating and hardwood pad.

For use in public buildings, schools and hospitals.

- Cleaners' sink
- Public building applications
- Splashback
- Bucket grating
- Hardwood pad



Illustrated

S5900 (0560A00)
Alder sink, 51cm with hardwood pad, 31cm high back and fitted stainless steel bucket grating
S7205 (6610400) Nimbus 1/2in inclined bib taps
S8331 (81460PR) 1/2in wall mounts for exposed plumbing
S8726 (70038P3) 1 1/2in unslotted strainer waste
S9221 (7931WDD) aluminium alloy build-in brackets
S9101 (7550BPR) Domex screws

Material

Fireclay

Weight

47.0kg

Colours

Available in White only

Options

S9233 (7930BWD)
Stainless steel legs and aluminium alloy bearers. Legs can be reduced in height on site

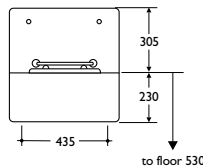
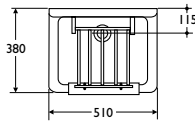

sinks
commercial



sinks

angus

General purpose cleaners' sink with 25cm high splashback and bucket grating.

Manufactured from 18 gauge stainless steel sheet with satin finish.

- Cleaners' sink
- Stainless steel
- Bucket grating
- Anti vandal

sinks
commercial



Illustrated

S5910 (5409100)
Angus sink, 44cm with 25cm high back, 1 1/2in integral strainer waste and stainless steel bucket grating
S7205 (6610400) Nimbus 1/2in inclined bib taps
S8331 (81460PR) 1/2in wall mounts for exposed plumbing
S8905 (70198Q4) 1 1/2in chrome plated bottle trap with 75mm seal

Material

Satin finish 18 gauge stainless steel

Weight

Sink 3.0kg

Special notes

The sink is fixed to wall with 4 screws through the back of the sink. This sink is not suitable for use with plastic bottle trap

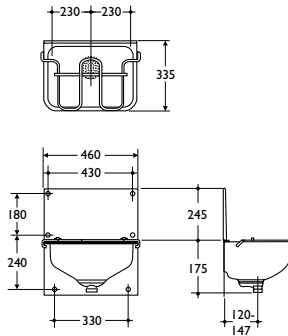

Armitage Shanks

Product information
Tel: 0870 122 8822 Fax: 0870 122 8282
eMail: info@thebluebook.co.uk
www.thebluebook.co.uk

12 : 2 : 2

CI/SIB (74) May 2002
Uniclass L721

Ideal Standard

sinks
belfast

Heavy duty sink in fireclay with weir overflow for commercial applications.

Sink is reversible and conforms to BS 1206:1974.

Reversible drainer and hardwood pad options.

- Three sizes
- Commercial application
- Conforms to BS 1206
- Hardwood pad option
- Reversible drainer



Illustrated

- S5805 (350086S) Belfast sink 61cm x 46cm x 26cm
- S7205 (6610400) Nimbus 1/2in inclined bib taps
- S8331 (81460PR) 1/2in wall mounts for exposed plumbing
- S8766 (70668M8) 1 1/2in slotted waste, chain and plug, screw stay
- S9250 (7930FVE) stainless steel legs and bearers
- S5835 (3507100) 61cm x 46cm plain drainer
- S9268 (7930JVE) stainless steel leg with screw to wall aluminium alloy bearer for drainer.

Material

Fireclay

Weight

- Sink 76cm 63.0kg
- 61cm 49.0kg
- 46cm 25.0kg
- Drainer 22.0kg

Options

- S9219 (7931VE0) aluminium alloy build-in brackets
- S9220 (7931VE1) aluminium alloy build-in bracket
- S5800 (350016S) Belfast sink 46 cm x 38cm x 21cm
- S9221 (7931WD0) brackets
- S9251 (7930FWD) legs and bearers
- S5811 (3500A6S) Belfast sink 76cm x 46cm x 26cm
- S5807 (35008PR) Belfast sink 61cm x 46cm x 26cm
- RH outlet, hardwood pad
- S5806 (35008PL) Belfast sink 61cm x 46cm x 26cm
- LH outlet, hardwood pad

Special notes

Stainless steel leg can be reduced in height on site

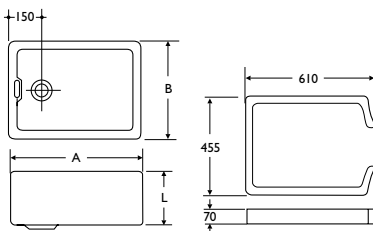

Colours

Available in White only

Standards

Sinks conform to BS 1206: 1974

Catalogue numbers, sizes and supports	Brackets		Legs and Bearers	
	A	B L	S9211	S9251
S5800	46x38x21cm		S9219	S9250
S5805	61x46x26cm		S9219	S9250
S5811	76x46x26cm		S9219	S9250

sinks

commercial

sinks
birch

Laboratory and cleaners' sink in fireclay manufactured in 2 sizes, 46cm x 38cm and 51cm x 38cm.

This heavy duty sink is available with plain edge or with hardwood pad.

For use in laboratories, public buildings, schools and hospitals.

- Heavy duty sink
- Cleaners' fittings option
- Institutional applications
- Two sizes

sinks
commercial



Illustrated

- S5915 (0565A00) Birch 46cm cleaners' sink with hardwood pad on front edge and fitted bucket grating
- S7205 (6610400) Nimbus 1/2in inclined bib taps
- S8331 (81460PR) 1/2in wall mounts for exposed plumbing
- S8726 (70038P3) 1 1/2in unslotted strainer waste
- S9221 (7931W00) aluminium alloy build-in brackets
- S9101 (7550BPR) Domex screws

Colours

Available in White only

Options

- S5920 (0565B00) 51cm cleaners' sink with hardwood pad on front edge and fitted bucket grating
- S5925 (351617F) 46cm laboratory sink with plain front edge
- S5930 (351627F) 51cm laboratory sink with plain front edge
- S9233 (7930BWD) Stainless steel legs and screw to wall aluminium alloy bearers.

Material

Fireclay

Weight

- 46cm 38.0kg
- 51cm 43.0kg

Special notes

Legs can be reduced in height on site

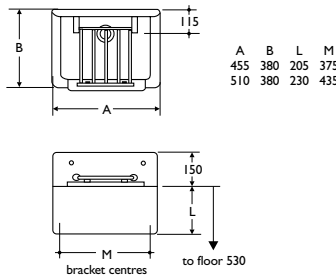

sinks
calder

Washing trough in stainless steel available with or without tapholes.

- Screw to wall
- Stainless steel
- Three standard lengths
- Bespoke sizes
- With or without tapholes



Illustrated

S2812 (543214W) Calder stainless steel washing trough 120cm long, with tapholes, right hand waste
S7231 (629141R) Avon self-closing non-concussive taps with spray (2)
S8760 (70658N0) 1 1/2in strainer waste
S8905 (70198Q4) 1 1/2in metal bottle trap, 75mm seal

Material

18 gauge stainless steel sheet

Weight

120cm 7.0kg
 180cm 10.0kg
 240cm 14.0kg

Finish

Polished stainless steel

Standards

Stainless steel sheet to BS 1449: Part 2: 1983

Options

S2810 (543214U) 120cm, tapholes, left hand waste
S2813 (543214X) 120cm, no tapholes, right hand waste
S2811 (543214V) 120cm, no tapholes, left hand waste
S2816 (543224W) 180cm, tapholes, right hand waste
S2814 (543224U) 180cm, tapholes, left hand waste
S2817 (543224X) 180cm, no tapholes, right hand waste
S2815 (543224V) 180cm, no tapholes, left hand waste
S2820 (543234W) 240cm, tapholes, right hand waste
S2818 (543234U) 240cm, tapholes, left hand waste
S2821 (543234X) 240cm, no tapholes, right hand waste
S2819 (543234V) 240cm, no tapholes, left hand waste

Associated products

S8335 (8147000) concealed inlet wall mounts (2)

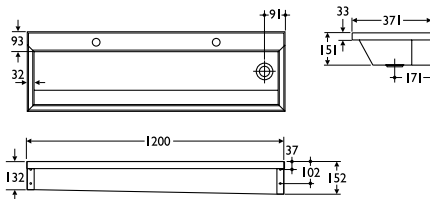

sinks

commercial



sinks

calder upstand

Washing trough with upstand in stainless steel, with or without tapholes.

- Screw to wall
- Stainless steel
- Three standard lengths
- Bespoke lengths available

sinks
commercial



Illustrated

S2833 (543314X) Calder upstand stainless steel washing trough with upstand back 120cm long, no tapholes, right hand waste
S7111 (697541G) Nuastyle 1/2in bib taps, dual index
S8331 (81460PR) exposed inlet wall mounts (pair)
S8760 (70658N0) 1 1/2in strainer waste
S8905 (70198Q4) 1 1/2in metal bottle trap, 75mm seal

Material

18 gauge stainless steel sheet

Weight

120cm 8.0kg
 180cm 12.0kg
 240cm 16.0kg

Finish

Polished stainless steel

Standards

Stainless steel sheet to BS1449: Part 2: 1983

Options

S2831 (543314V) 120cm, no tapholes, left hand waste
S2832 (543314W) 120cm, tapholes, right hand waste
S2830 (543314U) 120cm, tapholes, left hand waste
S2837 (543324X) 180cm, no tapholes, right hand waste
S2835 (543324V) 180cm, no tapholes, left hand waste
S2836 (543324W) 180cm, tapholes, right hand waste
S2834 (543324U) 180cm, tapholes, left hand waste
S2841 (543334X) 240cm, no tapholes, right hand waste
S2839 (543334V) 240cm, no tapholes, left hand waste
S2840 (543334W) 240cm, tapholes, right hand waste
S2838 (543334U) 240cm, tapholes, left hand waste

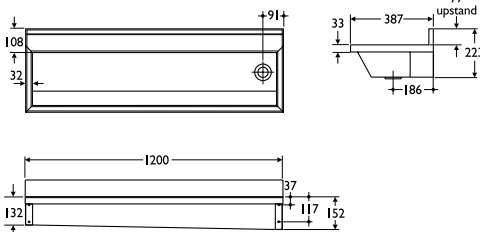

Armitage
Shanks

Product information
 Tel: 0870 122 8822 Fax: 0870 122 8282
 eMail: info@thebluebook.co.uk
www.thebluebook.co.uk

12 : 2 : 6

CI/SIB (74) May 2002
 Uniclass L721

Ideal
Standard

sinks
elm

Laboratory receiver sink, 33cm x 33cm, in fireclay for use as a plaster or sediment receiver, designed for use with galvanised tray.

- Laboratory receiver sink
- Galvanised tray
- Optional steel cover



Illustrated

S5955 (35151F8) Elm receiver 33cm horizontal outlet, no vent
 S9371 (7745000) stainless steel cover
 S9370 (7743000) galvanised tray

Material

Fireclay

Weight

Sink 34.0kg

Colours

Available in White only

Special notes

Outlet connectors to suit are available from Multikwik:
 Straight connector for 98-105mm I.D. soilpipe ref. MK55
 Offset connector for 98-105mm I.D. soilpipe ref. MK05

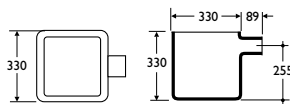

Receiver outlet 90 OD

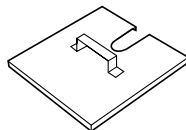

S9371 (7745000)

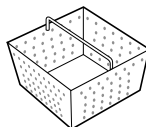

S9370 (7743000)

sinks

wansbeck

Shelf sink in fireclay with slot overflow and soap recess.

Suitable for commercial application.

Conforms to BS 1206: 1974.

- Slot overflow
- 61cm x 54cm
- Conforms to BS 1206
- Soap recess

commercial



Illustrated

S5820 (350216T)
 Wansbeck 61cm sink
 S7115 (6974400)
 Nuastyle 1/2in inclined high neck pillar taps
 S9300 (62904AT)
 1/2in extended inlet tails
 S8765 (70668M7)
 1 1/2in waste, chain and plug, bolt stay
 S9249 (7930FUF)
 stainless steel legs and aluminium alloy screw to wall bearers

Material

Fireclay

Weight

Sink 63.0kg

Colours

Available in White only

Standards

Conforms to BS 1206: 1974

Options

S9217 (7931UF0)
 aluminium alloy build-in brackets

Special notes

Legs can be reduced in height on site

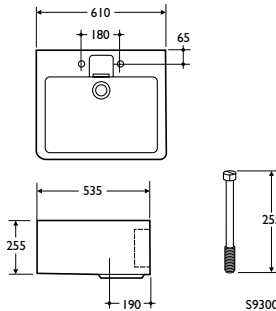

sinks

laboratory



sinks

laboratory

sinks

laboratory

*Armitage
Shanks*

*Ideal
Standard*

sinks

larch laboratory

Laboratory sink in fireclay.
Manufactured in 4 sizes with flanged edge and no overflow.

For fixing under benchtop.

- Resistant to acids and alkalis
- Fireclay sink
- Fixed under benchtop
- Four sizes
- No overflow



Illustrated

S5945 (351427C) Larch laboratory sink, flanged edge, 33cm x 26cm, no overflow
S9210 (72160Y4) fixing clips (set of 4)
S8776 (848279V) 1 1/4in acid resistant waste with loose lift out grid and 125mm stand tube overflow

Material

Fireclay

Weight

33cm x 26cm 15.0kg
 31cm x 31cm 15.0kg
 43cm x 33cm 23.0kg
 56cm x 36cm 29.0kg

Colours

Available in White only

Options

S5948 (351457C) flanged edge, 31cm x 31cm, no overflow
S5950 (351497C) flanged edge, 43cm x 33cm, no overflow
S5952 (3514C7C) flanged edge, 56cm x 36cm, no overflow
S8775 (848279U) 1 1/4in acid resistant waste with loose lift out grid and plug
S8777 (848279W) 1 1/4in acid resistant waste with loose lift out grid and 180mm stand tube overflow (56cm size)
S8990 (8496700) 1 1/4in acid resistant bottle trap with 75mm seal

Special notes

Use silicone sealant between sink and benchtop

sinks laboratory

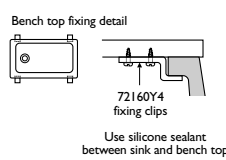
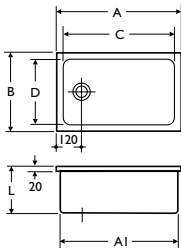

A	B	AI	BI	C	D	L
355	280	330	255	275	200	150
330	330	305	305	250	250	180
455	355	430	330	375	275	190
585	380	560	355	505	300	230



Armitage Shanks

Product information
 Tel: 0870 122 8822 Fax: 0870 122 8282
 eMail: info@thebluebook.co.uk
www.thebluebook.co.uk

12:3:1

CI/SIB (74) May 2002 Uniclass L721

Isogl Standard

sinks

fittings



sinks

fittings

sinks

wall mounts • wastes • traps

Fittings for sinks.

- Wall mounts
- Wastes
- Bottle traps



S8775



S8776



S8775/
S8776



S8335



S8726



S8345



S8765



S8330

● Wall mounts

Illustrated

S8330 (8146000CP) chrome plated, 1/2in wall mount for exposed plumbing
S8335 (8147000CP) chrome plated, 1/2in wall mount for concealed plumbing
S8345 (8174B00CP) chrome plated, 1/2in extension 75mm long

Options

S8331 (81460PRCP) 1/2in wall mounted for exposed plumbing (pair)
S8336 (81470PRCP) 1/2in wall mounted for exposed plumbing (pair)
S8346 (8174BPRCP) 1/2in extension 75mm long (pair)

● Wastes

Illustrated

Chrome plated, 1/2in wastes with chain and plug
S8768 (70668M0CP) 90mm unslotted tail, screw stay;
S8765 (70668M7CP) 90mm slotted tail, bolt stay
S8766 (70668M8CP) 90mm slotted tail, screw stay.

Chrome plated, 1/2in strainer wastes
S8726 (70038P3CP) 80mm unslotted tail;
S8725 (70038P2CP) 80mm but slotted tail. Self-colour, 1/4in acid resistant wastes;
S8775 (848279USC) with plug;
S8776 (848279VSC) with 125mm stand tube overflow;
S8777 (848279WSC) with 180mm stand tube overflow

● Bottle traps

Illustrated

S8915 (70238Q45C) self-colour, 1/2in plastic bottle trap with 75mm seal, multi-purpose outlet
S8925 (73608005C) self-colour, 1/2in plastic resealing bottle trap with 75mm seal, multi-purpose outlet
S8905 (70198Q4CP) chrome plated, 1/2in

bottle trap with 75mm seal. Outlet screwed 1/2in BSP male with compression nut and ring
S8990 (84967005C) self-colour, 1/4in acid resistant bottle trap with 75mm seal, outlet screwed 1/2in male with compression nut and ring (not illustrated)



S8915



S8925



S8905

sinks

brackets • legs • bearers

Fittings for sinks.

Build-in brackets in aluminium alloy.

Legs in polished stainless steel and screw to wall bearers in aluminium alloy.

- Build-in brackets
- Aluminium alloy with bearers
- Stainless steel legs

sinks
fittings

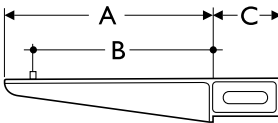
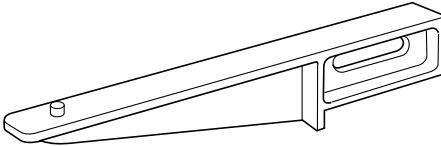

- Build-in brackets
- Aluminium alloy

Catalogue numbers and sizes

	A Bracket	B Stud	C Build-in	
S9221 (7931W00 SC)	355	305	115	Pair
S9219 (7931VE0 SC)	405	355	115	Pair
S9220 (7931VE1 SC)	405	355	115	Single
S9217 (7931UF0 SC)	455	405	115	Pair
S9218 (7931UF1 SC)	455	405	115	Single
S9215 (7931TG0 SC)	510	455	150	Pair

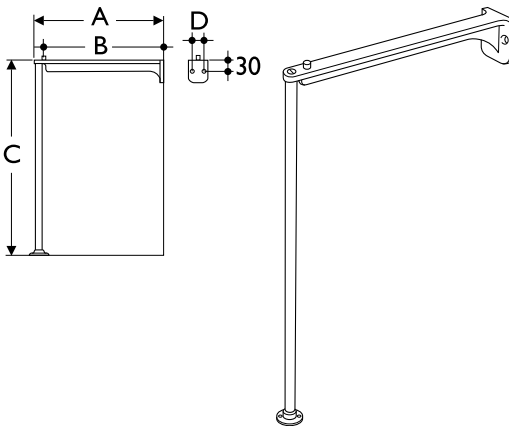

- Polished stainless steel legs
- Screw to wall bearers

Catalogue numbers and sizes

	A Bearer	B Stud	C Leg	D	
S9233 (7930BWD PO)	355	305	350	30	Pair
S9251 (7930FWD PO)	355	305	650	30	Pair
S9232 (7930BVE PO)	405	355	350	30	Pair
S9250 (7930FVE PO)	405	355	650	30	Pair
S9268 (7930JVE PO)	405	355	900	30	Single
S9249 (7930JUF PO)	455	405	650	35	Pair
S9267 (7930JUF PO)	455	405	900	35	Single
S9248 (7930FTG PO)	510	455	650	35	Pair
S9247 (7930FSH PO)	560	510	650	35	Pair