

X120 thermostatic shower bar valve

cool touch safety feature

ceramic cartridge



X120 Thermostatic Shower Bar Valve

X120 thermostatic shower bar valve

X120 Thermostatic Shower Bar Valve **X205012CP**

shower rail

Sola shower rail, hose & head **SF1251CP**

finish

Chrome plated CP.

approvals

Product manufactured from WRAS approved materials

standards

Chrome plated to BS EN248

system requirements

Gravity fed hot & cold (equal pressures)
 Gravity fed hot & mains cold
 (Differential pressure, max ratio 5:1)
 Unvented systems
 Instantaneous water heater (Combination boiler)
 Pumped system

Minimum cold water supply temp = 5°C

Maximum cold water supply temp = 25°C

Maximum Hot water supply temp = 80°C

recommended operating pressure

Minimum operating pressure 0.5 bar.

Maximum operating pressure 5 bar.

note

Temperature pre set to 38°C. With push button override to 46°C. Will fit a standard 1/2" BSP hose connector. Includes a water saving eco feature, to control flow.

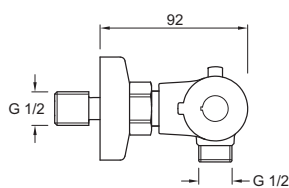
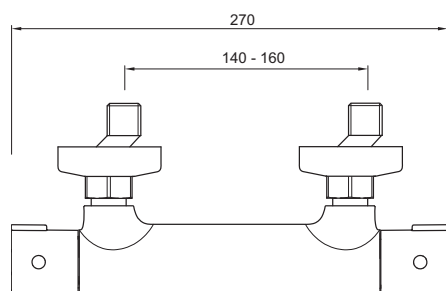

Thermostatic Bar Shower Valve – X205012CP

Flow Rate (Litres per minute)	0.5 Bar	1 Bar	2 Bar	3 Bar	4 Bar	5 Bar
Without Flow Regulator Fitted	7.3	11.3	16.4	20.4	24.0	27.0
Flow Limiter Fitted (Part No:XS9008XX)	4.9	6.8	7.3	7.5	7.8	8.0

All measurements shown are in millimetres. Drawing sizes are not to scale.
 to specify/order: Please use the 8 or 9 character reference shown above.

Lawton Road, Alsager, Stoke-on-Trent ST7 2DF, UK
 Tel: +44(0) 1270 879777 Fax: +44(0) 1270 873864
 www.twyfordbathrooms.com UK Technical Helpline Tel: 0844 412 5921/01270 871 480

Twyford