



Kinloch Trough Urinal, 120cm Top Inlet, Central Outlet

Illustrated

S6388 Kinloch urinal 120cm long complete with 2" domed strainer waste, central outlet, complete with flushpipes and autocistern

Configuration options

- S6384** Kinloch urinal to special length, up to 120cm long complete with 2" domed strainer waste, central outlet
- S6385** Kinloch urinal to special length, up to 180cm long complete with 2" domed strainer waste, central outlet
- S6386** Kinloch urinal to special length, up to 240cm long complete with 2" domed strainer waste, central outlet
- S6387** Kinloch urinal to special length, up to 305cm long complete with 2" domed strainer waste, central outlet
- S6389** Kinloch urinal 180cm long complete with 2" domed strainer waste, centre outlet, complete with flushpipes and autocistern
- S6390** Kinloch urinal 240cm long complete with 2" domed strainer waste, centre outlet, complete with pipework and autocistern
- S6391** Kinloch urinal 305cm long complete with 2" domed strainer waste, centre outlet, complete with pipework and autocistern
- S6205** Kinloch urinal corner plinth, stainless steel
- S6206** Kinloch urinal cover strip to join separate urinals

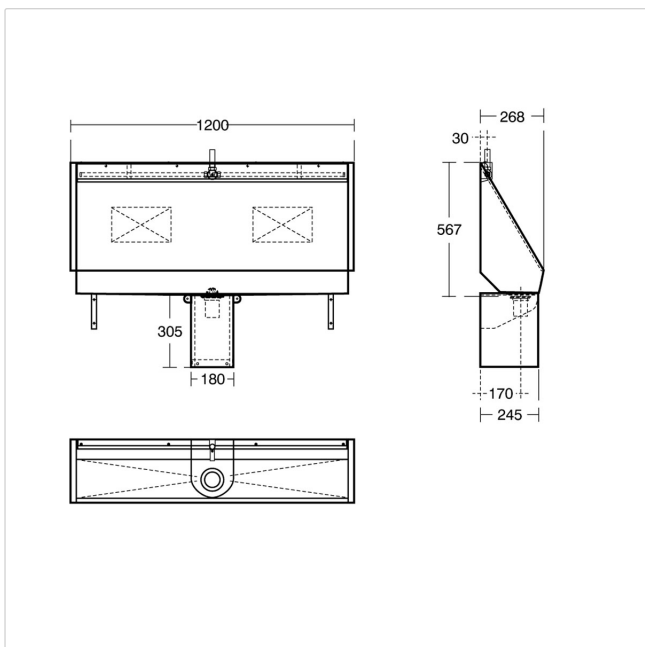

Material

Stainless Steel

Weights

S6388 20.60KG

Colours

Stainless Steel (MY)

Standards

Manufactured from 1.5mm Stainless Steel 1.4301 (304) to BSEN 10088: part 2: 2005

Special Notes

Kinloch urinal complete with central domed strainer waste 2in BSP outlet. Knock out inlet position allows pipework to be exposed or concealed.

Urinals on 2 or more walls can be joined using S6206MY stainless steel cover strip and S6205MY stainless steel corner plinth.

Frequently used applications

- | | |
|-----------------|--------------------|
| Education | Factory |
| Hotels | Office |
| Public Building | Pubs and Clubs |
| Retail | Sports and Leisure |
| Vandal Risk | |

Features

Water Saving