

High Neck Sink Tap

GENERAL INFORMATION

Pattern No. key :HN = High Neck, INC = Inclined

Size	Pattern No.	Box Qty	Code	Barcode	Price (£) ex VAT
1/2	159HN INC Hot	4	306007	5013866015663	£26.37
1/2	159HN INC Cold	4	306017	5013866015670	£26.37
1/2	159HN INC	1 Pair	306040	5013866037214	£52.73

DIMENSIONS (mm)

Code	Description	A	B	C	D	E
306007	1/2 159 HN CP PERFORMA SINK TAP HOT	50	1/2" BSP	96	102	205

PRESSURE & TEMPERATURE

Sink Taps	Minimum Operating Pressure (bar)	Maximum Cold Working Pressure (bar)	Maximum Hot Working Pressure (bar)
1/2 159 HN CP PERFORMA SINK TAP HOT	0.1 bar	10.0 bar at temperatures up to 85°C	Not Suitable for Maximum Hot Working Pressure

MATERIAL SPECIFICATIONS

Number	Component	Material
1	Body	Forged Brass with Chrome Plate
2	Backnut	Forged Brass
3	Anti-rotational washer	Polyethelene
4	Head	Brass Bar
5	Spindle	Brass Bar
6	Cross Tap	Forged Brass
7	Valve	Brass Bar
8	Gland	Brass Bar
9	Packing	Plastic
10	Seals	Rubber

SPARES

159HN INC Hot - Size - 1/2

Spare Key	Description	Code	Barcode	Date From	Date To	Price (£) ex VAT
1	INH1 INDICE HOT	814001	5013866056314	All variations		£1.44
2	HKH1CP COMPLETE HEADWORK HOT CHROME 1/2	814005	5013866056338	January 01 2001	To Current	£17.68
2	HKH14CP COMPLETE HEADWORK HOT CHROME 1/2	814104	5013866056529	January 01 1990	December 31 2000	£17.68
3	VWA5 VALVE WASHER ASSEMBLY	814120	5013866056567	January 01 1990	December 31 2000	£2.41
3	VWA3 VALVE WASHER ASSEMBLY	814009	5013866056376	January 01 2001	December 31 2000To Current	£3.49
4	VW16 VALVE WASHER	811082	5013866053948	January 01 2001	December 31 2000To Current	£0.68
4	VW17 VALVE WASHER	811209	5013866054181	January 01 1990	December 31 2000	£1.37
5	SW3 HEAD / BODY WASHER	814133	5013866056673	January 01 1990	December 31 2000	£0.77
5	OR12 O RING	811084	5013866053955	January 01 2001	December 31 2000To Current	£0.68
6	ARW2 1/2 ANTI ROTATIONAL WASHER	814162	5013866056758	All variations		£1.44
7	1/2 BN 915 BACKNUT	817071	5013866023354	All variations		£2.41

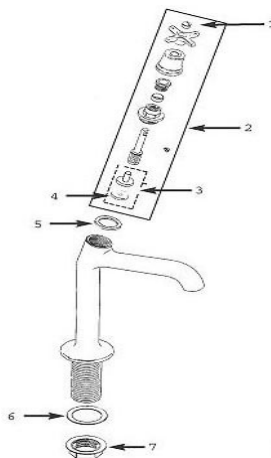

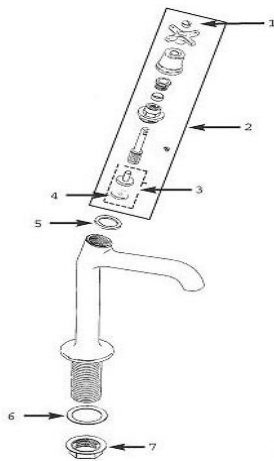

159HN INC Cold - Size - 1/2						
Spare Key	Description	Code	Barcode	Date From	Date To	Price (£) ex VAT
1	INC1 INDICE COLD	814002	5013866056321	All variations		£1.44
2	HKC14CP COMPLETE HEADWORK COLD CP 1/2	814105	5013866056536	January 01 1990	December 31 2000	£17.68
2	HKC1CP COMPLETE HEADWORK COLD CHROME 1/2	814006	5013866056345	January 01 2001	December 31 2000To Current	£17.68
3	VWA5 VALVE WASHER ASSEMBLY	814120	5013866056567	January 01 1990	December 31 2000	£2.41
3	VWA3 VALVE WASHER ASSEMBLY	814009	5013866056376	January 01 2001	December 31 2000To Current	£3.49
4	VW16 VALVE WASHER	811082	5013866053948	January 01 2001	December 31 2000To CurrentTo Current	£0.68
4	VW17 VALVE WASHER	811209	5013866054181	January 01 1990	December 31 2000	£1.37
5	OR12 O RING	811084	5013866053955	January 01 2001	December 31 2000To Current	£0.68
5	SW3 HEAD / BODY WASHER	814133	5013866056673	January 01 1990	December 31 2000	£0.77
6	ARW2 1/2 ANTI ROTATIONAL WASHER	814162	5013866056758	All variations		£1.44
7	1/2 BN 915 BACKNUT	817071	5013866023354	All variations		£2.41

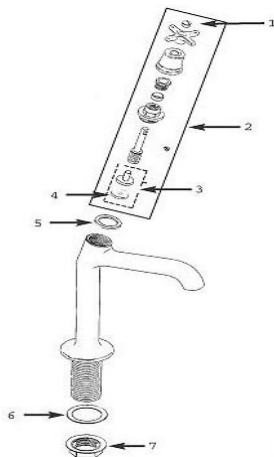

159HN INC - Size - 1/2						
Spare Key	Description	Code	Barcode	Date From	Date To	Price (£) ex VAT
1	INC1 INDICE COLD	814002	5013866056321	January 01 2001	To Current	£1.44
1	INH1 INDICE HOT	814001	5013866056314	All variations		£1.44
2	HKH1CP COMPLETE HEADWORK HOT CHROME 1/2	814005	5013866056338	January 01 2001	To CurrentTo Current	£17.68
2	HKC1CP COMPLETE HEADWORK COLD CHROME 1/2	814006	5013866056345	January 01 2001	To CurrentTo CurrentTo Current	£17.68
2	HKH14CP COMPLETE HEADWORK HOT CHROME 1/2	814104	5013866056529	January 01 1990	December 31 2000	£17.68
2	HKC14CP COMPLETE HEADWORK COLD CP 1/2	814105	5013866056536	January 01 1990	December 31 2000	£17.68
3	VWA3 VALVE WASHER ASSEMBLY	814009	5013866056376	January 01 2001	December 31 2000To Current	£3.49
3	VWA5 VALVE WASHER ASSEMBLY	814120	5013866056567	January 01 1990	December 31 2000	£2.41
4	VW16 VALVE WASHER	811082	5013866053948	January 01 2001	December 31 2000To Current	£0.68
4	VW17 VALVE WASHER	811209	5013866054181	January 01 1990	December 31 2000	£1.37
5	OR12 O RING	811084	5013866053955	January 01 2001	December 31 2000To Current	£0.68
5	SW3 HEAD / BODY WASHER	814133	5013866056673	January 01 1990	December 31 2000	£0.77
6	ARW2 1/2 ANTI ROTATIONAL WASHER	814162	5013866056758	All variations		£1.44
7	1/2 BN 915 BACKNUT	817071	5013866023354	All variations		£2.41

CARE & MAINTENANCE

Care

To maintain the surface finish, simply wipe occasionally with a mild detergent on a soft damp cloth. Dry, using a soft cloth. Never use abrasive cleaners or chemical household cleaners and avoid contact with concentrated bleach.

Maintenance

No regular maintenance is required for this product.

In case of complete replacement Pegler recommend service valves should be fitted to the supply inlets.

For any further help or replacement parts please contact the Service Support Team on 0800 1560050.

REGULATIONS

Regulations

It is important to ensure that the water supplies to your taps and mixers are connected in accordance with the water regulations (WRAS) requirements and good plumbing practice.

If the water flow streams are separate all the way to the outlet of the fitting, then there is no requirement to fit check valves to the cold and hot pipes even if the supply pressures are unbalanced.

GUARANTEE

Luxury Taps and Mixers

Pegler Yorkshire Customcare 5 Year Guarantee - Terms and Conditions

Product are subject to a 5 year guarantee that is between Pegler Yorkshire and the final purchaser of the product.

The guarantee is subject to proof of purchase being supplied.

This guarantee does not affect any statutory rights the consumer may have in law.

The guarantee covers manufacturing or material defects and does not cover parts subject to normal wear and tear.

This product has been designed for the use of homeowners and domestic users and therefore the guarantee is subject to products being fitted in domestic circumstances such as UK housing stock.

Finishes other than chrome are covered for a period of 3 years only and the guarantee on the finish is subject to the cleaning instructions being followed.

The guarantee is not applicable where the product is fitted contrary to the conditions in the fitting instructions.

Abusive behaviour and accidental damage to the product are not covered by this guarantee.

The extent of this liability is limited to the cost of the replacement of the defective item and not to fitting or consequential damages.

APPROVALS



Kitemarked BS 1010 : Part
2