

AFTERCARE INSTRUCTIONS

Your fitting has a high quality finish and should be treated with care to preserve the visible surfaces. All surface finishes will wear if not cleaned correctly, the only safe way to clean your mixer is to wipe with a soft damp cloth. Stains can be removed using washing up liquid. All bath cleaning powders and liquids will damage the surface of your fitting - even non-scratch cleaners.

GUARANTEE

All products are manufactured to the highest standards and a 5 year guarantee covers any defect in manufacture.

NOTE: The 5 year guarantee on the valves is invalidated if damaged by any waterborne debris.

In the interests of continuous product development we reserve the right to alter specification as necessary.

PRODUCT CODES:

**DUC HNK C, DUC DSM C, DUC SNK C
DUX HNK C, DUX DSM C, DUX SNK C
DUL HNK C, DUL DSM C, DUL SNK C**

TELEPHONE HELP LINE: 0844 701 6273

Bristan Group Ltd
Birch Coppice Business Park
Dordon
Tamworth
Staffordshire
B78 1SG
UK
A Masco Company

Web Site: www.bristan.com
Telephone: 0844 701 6274
Facsimile: 0844 701 6275
Email: enquire@bristan.com

BRISTAN

Design Utility Kitchen Ranges (Club, Crosshead and Lever)

Fitting Instructions



Before starting any installation project, consider 'safety' first. Look for the 'safety note' and read the safety advice.

Please leave these instructions with the user.

WATER PRESSURE

These products are suitable for use at all supply pressures. If installed at low pressure (tank fed), then the minimum distance from the outlet of the nozzle to the underside of the cold tank should be approximately 2 metres to ensure adequate performance. The taps should be installed in compliance with Water Regulations. For further details contact your Local Water Authority.

HIGH NECK TAPS

1. Identify all components and check for completeness, particularly before arranging fitting.
2. Install the taps (3) to the basin/sink. The backnut (1) and backnut washer (2) are used under the basin/sink to secure the tap to the surfaces of basin/sink.
3. Connect the hot and cold water supplies to the taps.
4. Turn on the water supplies. Open both taps letting the water flow for a few minutes to check all joints and connections for leaks.
5. See the back page for aftercare instructions.

CONTENTS

- | | |
|-------------------|------|
| 1. Backnut | (x2) |
| 2. Backnut Washer | (x2) |
| 3. Body | (x2) |
| 4. Valve | (x2) |
| 5. Handle | (x2) |
| 6. Handle Screw | (x2) |
| 7. Indices | (x2) |

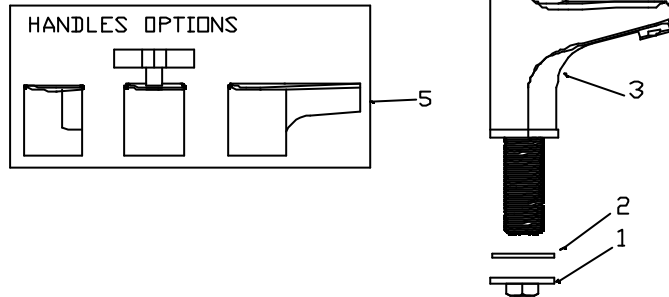

DECK SINK MIXER

1. Identify all components and check for completeness, particularly before arranging fitting.
2. Attach the spout into the body (3), secure in place with grub screw ensuring the spout is able to rotate freely.
3. Fit the mixer to the sink using the backnut washers (2) and backnuts (1) below the surface. Then connect the hot and cold water supplies to the mixer.
4. Fully open both valves, letting them run for a few minutes to check all joints and connections for leaks.
5. See the back page for aftercare instructions.

CONTENTS

- | | |
|-------------------|------|
| 1. Backnut | (x2) |
| 2. Backnut Washer | (x2) |
| 3. Body | (x1) |
| 4. Valve | (x2) |
| 5. Handle | (x2) |
| 6. Handle Screw | (x2) |
| 7. Indices | (x2) |

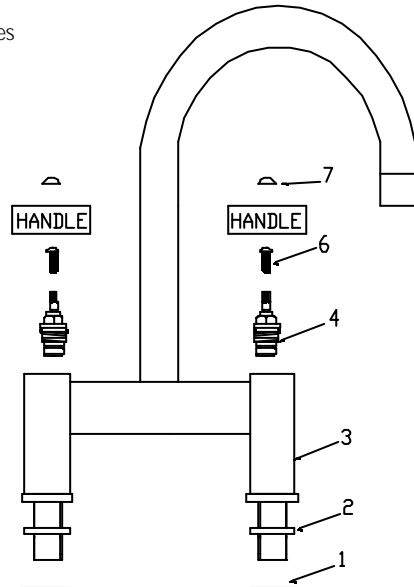

SINK MIXER

1. Identify all components and check for completeness, particularly before arranging fitting.
2. Fit the mixer (3) to the sink using the fixing kit (10).
3. Screw in connecting copper tail pipes (11) by hand into base of the mixer and then connect the hot and cold supplies.
4. Fully open both valves, letting it run for a few minutes to check all joints and connections for leaks.
5. See over the page for aftercare instructions.

CONTENTS

- | | |
|-----------------|------|
| 3. Body | (x1) |
| 4. Valve | (x2) |
| 5. Handle | (x2) |
| 6. Handle Screw | (x2) |
| 7. Indices | (x2) |
| 10. Fixing Kit | (x1) |
| 11. Tail Pipes | (x2) |
| 12. Shrouds | (x2) |
| 16. Grub Screw | (x1) |

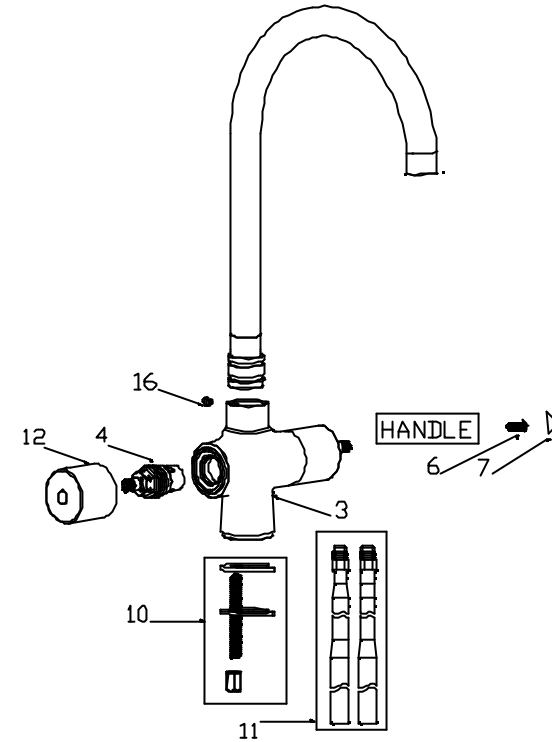

MAINTENANCE

If any of the fittings begin to drip:

1. Turn off the water supply.
2. Remove indices cap (7) and screw (6), and then remove the handle (5) by pulling from valve (4). Then remove valve (4).
3. Once removed, carefully clean seating, rubber washer and ceramic disc.
4. Replace all of the above then turn on the water supply.
5. If problem persists contact our helpline quoting the product code.

Please Note: In the unlikely event you find a part missing please contact our Customer Service Helpline on 0844 701 6273 or email enquire@bristan.com for immediate despatch of part.