



AFTERCARE INSTRUCTIONS

Your fitting has a high quality finish and should be treated with care to preserve the visible surfaces. All surface finishes will wear if not cleaned correctly, the only safe way to clean your mixer is to wipe with a soft damp cloth. Stains can be removed using washing up liquid. All bath cleaning powders and liquids will damage the surface of your fitting even the non-scratch cleaners.

GUARANTEE

All products are manufactured to the highest standards and a 5 year guarantee covers any defect in manufacture.

NOTE: The 5 year guarantee on the valves is invalidated if damaged by any waterborne debris.

In the interests of continuous product development Bristan reserve the right to alter specification as necessary.

PRODUCT CODE: VI SNK C
TELEPHONE HELPLINE: 0844 701 6273

Bristan Group Ltd
Birch Coppice Business Park
Dordon
Tamworth
Staffordshire
B78 1SG
UK
A Masco Company

Web Site: www.bristan.com
Telephone: 0844 701 6274
Facsimile: 0844 701 6275
Email: enquire@bristan.com

(FI VI SNK)

(Rev. D1)

(SM)

BRISTAN

Vinca Sink Mixer with Pull Out Spray

Fitting Instructions

Please keep these instructions for future reference and request of replacement parts.



WATER PRESSURE

This mixer is suitable for use at pressures of 1 bar or more. This mixer should be installed in compliance with Water Regulations. For further details contact your Local Water Authority.

Please note that this mixer is supplied with check valves pre-fitted into the inlet tail pipes to prevent backflow i.e. Cold from the mains and hot via a hot water cylinder.

CONTENTS

1. Handle
2. Cartridge Retaining Nut
3. Cartridge
4. Fixing Kit
5. Flexible Inlet Tail Pipes
6. Plinth

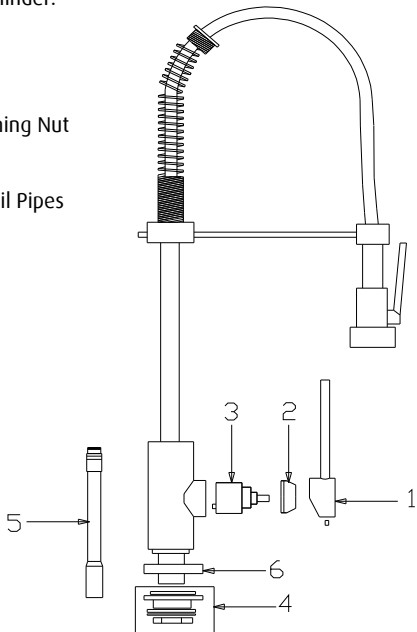

Please Note: In the unlikely event you find a part missing please contact our Customer Service Help line on 0844 701 6273 for immediate dispatch of part.

INSTALLATION

1. Identify all components and check for completeness, particularly before arranging installation.
2. Thread the tailpipes (5) through the hole in the sink, positioning the base on the sink with plinth (6).
3. Secure into position using the fixing kit (4).
4. Fit the tail pipes (5) to the fitting and then connect the hot and cold supplies.
5. Fully open the cartridge letting it run for a few minutes and check all joints and connections for leaks.
6. See over the page for aftercare instructions.

MAINTENANCE

If the fitting begins to drip:

1. Isolate water supplies.
2. Unscrew the grub screw and remove handle (1).
3. Remove the retaining nut (2) and then lift out the cartridge (3).
4. Clean or replace cartridge (3), clean and grease seal and refit. Please note that there are locating pins on the bottom of the cartridge that fit in holes inside the tap, to ensure it is fitted the right way round.
5. Refit the cartridge retaining nut (2) and reassemble handle.
6. If problem persists contact our helpline quoting the product code overleaf.