

AFTERCARE INSTRUCTIONS

Your fitting has been manufactured to a high quality finish therefore should be treated with care to preserve its visible appearance. All surface finishes will wear if not cleaned correctly, the recommended and safest way to clean your fitting is to wipe with a soft damp cloth. Stains can be removed using washing up liquid. All domestic cleaning products, including non-scratch cleaners, can damage the surface and appearance of your fitting.

GUARANTEE

All products are manufactured to the highest standards and a 5 year guarantee covers any defect in manufacture. As gold and special effect finishes are softer than chromium plate, special care must be taken when cleaning; a 3 year guarantee covers these finishes.

NOTE: The 5 year guarantee on the valves is invalidated if damaged by any waterborne debris.

In the interests of continuous product development we reserve the right to alter specification as necessary.

PRODUCT CODE: BL BSM C
TELEPHONE HELPLINE: 0844 701 6273

Bristan Group Ltd
Birch Coppice Business Park
Dordon
Tamworth
Staffordshire
B78 1SG
UK
A Masco Company

Web Site: www.bristan.com
Telephone: 0844 701 6273
Facsimile: 0844 701 6275
Email: enquire@bristan.com

BRISTAN

Blade Deck Mounted Bath Shower Mixer



Prior to drilling into walls, check there are no hidden electrical wires, cables or water supply pipes with the aid of an electronic detector. If you use power tools do not forget:

- Wear eye protection
- Unplug equipment after use

Fitting Instructions & Contents List

Please keep these instructions for future reference and request of replacement parts.

(F) BL BSM)

(R3)

(U)

For latest prices and delivery to your door visit MyTub Ltd 0845 303 8383 www.mytub.co.uk

WATER PRESSURE

This mixer is suitable for use at all supply pressures. However for optimum use both the hot and cold supplies should be reasonably balanced. If the fitting is installed at low pressure (tank fed), then the minimum height from the highest installed position of the showerhead to the underside of the cold tank should be 1.0 metre to ensure adequate shower performance.

This mixer should be installed in compliance with Water Regulations. Where the supplies are unbalanced, i.e. hot water from cylinder tank/cold from the mains, approved check valves must be fitted in the supply pipes. For further details contact your Local Water Authority.

INSTALLATION DIAGRAM

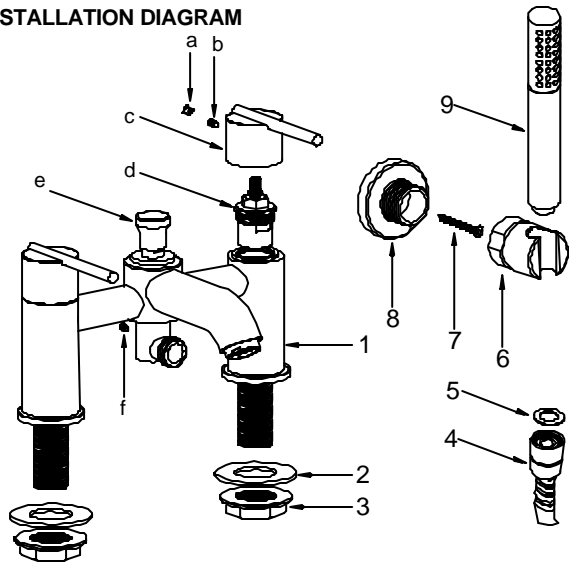

Please Note: In the unlikely event you find a part missing please contact our Customer Service Help line on 0844 701 6273 for immediate dispatch of part.

CONTENTS

1. Mixer Body	(x1)	6. Handset Holder	(x1)
2. Rubber Washer	(x2)	7. Fixing Screw	(x1)
3. Backnut	(x2)	8. Wall Bracket	(x1)
4. Hose	(x1)	9. Handset	(x1)
5. Small Washer	(x2)		

INSTALLATION

1. Identify all components and check for completeness, particularly before arranging fitting.
2. Fit the mixer body (1) to the bath and secure using the rubber washers (2) and backnuts (3) below the bath. Connect the hot and cold water supplies.
3. Fit the hose (4) to the mixer (1) and the handset (9) using the small sealing washers (5). To adjust hose outlet position; loosen screw (f) then rotate hose outlet to desired position. Secure in place with grub screw (f).



Prior to drilling into walls, check there are no hidden electrical wires, cables or water supply pipes with the aid of an electronic detector. If you use power tools do not forget to:

- Wear eye protection
 - Unplug equipment after use
4. Fix wall bracket (8) to wall using the screw (7) and wall plug provided, ensuring that the handset will reach it. Attach bracket handset holder (6).
 5. Fully open both valves letting them run for a few minutes, check all joints and connections for leaks.
 6. Operate the mixer in both bath and shower mode. To switch from bath to shower mode, pull the diverter knob (e) up. After use the mixer automatically reverts to the bath-filling mode.

MAINTENANCE

If the fitting begins to drip:

1. Turn off the water supply.
2. Prise out cap (a), loosen grub screw (b) and lift off handle (c).
3. Remove valve (d). Clean seating, seal and ceramic disc.
4. Replace valve and head and turn on the water supply.
5. Contact our helpline if problem persists.