

AFTERCARE INSTRUCTIONS

Your fitting has a high quality finish and should be treated with care to preserve the visible surfaces. All surface finishes will wear if not cleaned correctly, the only safe way to clean your mixer is to wipe with a soft damp cloth. Stains can be removed using washing up liquid. All bath cleaning powders and liquids will damage the surface of your fitting even the non-scratch cleaners.

GUARANTEE

All products are manufactured to the highest standards and a 5 year guarantee covers any defect in manufacture. As gold and special effect finishes are softer than chromium plate, special care must be taken when cleaning; a 3 year guarantee covers these finishes.

NOTE: The 5 year guarantee on the valves is invalidated if damaged by any waterborne debris.

In the interests of continuous product development we reserve the right to alter specification as necessary.

TELEPHONE HELP LINE: 0844 701 6273

Bristan Group Ltd
Birch Coppice Business Park
Dordon
Tamworth
Staffordshire
B78 1SG
UK
A Masco Company

Web Site: www.bristan.com
Telephone: 0844 701 6273
Facsimile: 0844 701 6275
Email: enquire@bristan.com

(FI ON 1HBF)

(Rev. D3)

(U)

BRISTAN

Options One Hole Bath Filler

Fitting Instructions & Contents List

**Please keep these instructions for future reference
and for the ordering of spare parts.**



For latest prices and delivery to your door visit MyTub Ltd 0845 303 8383 www.mytub.co.uk

WATER PRESSURE

This mixer is suitable for use at pressures of 0.5 bar or more. If the fitting is tank fed, then the minimum height from the outlet of the nozzle to the underside of the cold tank should be 5 metres to ensure adequate performance. For optimum use both the hot and cold supplies should be reasonably balanced.

This mixer should be installed in compliance with Water Regulations. For further details contact your Local Water Authority.

CONTENTS

- | | |
|-----------------------|------|
| 1. Mixer Body | (x1) |
| 2. Full Rubber Washer | (x1) |
| 3. Rubber 'C' Washer | (x1) |
| 4. Metal 'C' Washer | (x1) |
| 5. Threaded Rod | (x1) |
| 6. Fixing Nut | (x1) |
| 7. Copper Tail Pipes | (x2) |
| a. Valve | (x2) |
| b. Handle | (x2) |

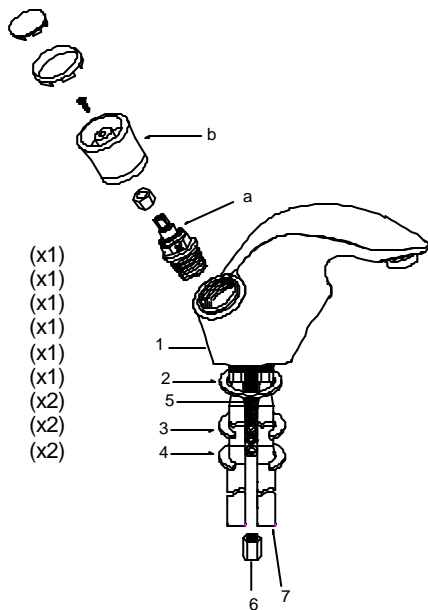

Please Note: Handles must be bought separately.

INSTALLATION

1. Identify all components and check for completeness, particularly before arranging fitting.
2. Install the mixer body (1) to the bath using the 'C' plate fixing kit. The full rubber washer (2) goes between the fitting and the bath, and the 'C' shaped rubber (3) and metal washers (4) on the underside of the bath, to be secured by the nut (6) and threaded rod (5).
3. Fit the tailpipes (7) to the fitting and connect the hot and cold supplies.
4. Turn on the water supplies. Turn on both hot and cold taps for a few minutes letting the water flow, to check all joints and connections for leaks.
5. See over the page for aftercare instructions.

MAINTENANCE

If the fitting begins to drip:

1. Turn off the water supply.
2. Disassemble/remove handle (b), unscrew retaining screw and lift off the handle. Handle assembly varies.
3. Using a suitable spanner, remove valve (a). Once removed, carefully clean seating, rubber washer and/or ceramic disc.
4. Replace all of the above then turn on the water supply.
5. If problem persists contact our helpline quoting the product code.

Please Note: In the unlikely event you find a part missing please contact our Customer Service Help line on 0844 701 6273 for immediate dispatch of part.