



AFTERCARE INSTRUCTIONS

Your fitting has a high quality finish and should be treated with care to preserve the visible surfaces. All surface finishes will wear if not cleaned correctly, the only safe way to clean your waste is to wipe with a soft damp cloth. Stains can be removed using washing up liquid. All bath cleaning powders and liquids will damage the surface of your fitting even the non-scratch cleaners.

GUARANTEE

All products are manufactured to the highest standards and a 5 year guarantee covers any defect in manufacture. As gold and special effect finishes are softer than chromium plate, special care must be taken when cleaning, a 3 year guarantee covers these finishes.

NOTE: - The 5 year guarantee is invalidated if damaged by any waterborne debris.

In the interests of continuous product development Bristan reserve the right to alter specification as necessary

PRODUCT NAME:

PRODUCT CODE:

TELEPHONE HELP LINE! 0844 701 6273

Bristan Group Ltd
Birch Coppice Business Park
Dordon
Tamworth
Staffordshire
B79 1SG
U.K.

Web Site: www.bristan.com

Telephone: 0844 701 6274

Facsimile: 0844 701 6275

(FI ON BASBID 5-11-2007)

(R2)

(G)

BRISTAN

Options Monobloc Basin or Bidet Mixer

Fitting Instructions & Contents List

Please keep these instructions for future reference and for the request of spare parts

WATER PRESSURE

This mixer is suitable for use at all supply pressures. However for optimum use both the hot and cold supplies should be reasonably balanced. If the fitting is installed at low pressure (tank fed), then the minimum distance from the outlet of the nozzle to the underside of the cold tank should be approximately 2 metres to ensure adequate performance.

This mixer should be installed in compliance with Water Regulations. Where the supplies are unbalanced, i.e. hot water from the cylinder tank / cold from the mains, approved check valves must be fitted in the supply pipes. For further details contact your Local Water Authority.

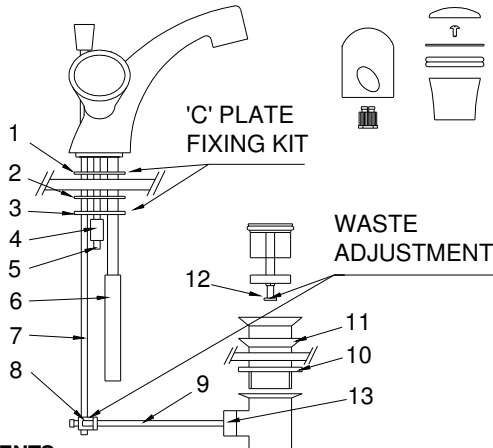

CONTENTS

- | | |
|---------------------------|-----------------------------|
| 1. Full rubber washer | 8. Waste Connecting Bracket |
| 2. C-shaped rubber washer | 9. Horizontal Waste Rod |
| 3. C-shaped metal washer | 10. Flat Washer |
| 4. Nut | 11. Shaped Washer |
| 5. Threaded Rod | 12. Adjustment Screw |
| 6. Tailpipes | 13. Waste Body |

7. Pop-Up Operating Rod INSTALLATION

1. Identify all components and check for completeness, particularly before arranging fitting.
2. Fit the mixer body to the basin/bidet using the 'C' plate fixing kit. The full rubber washer (1) goes between the fitting and the basin/bidet, and the 'C' shaped rubber (2) and metal washers (3) on the underside of the basin/bidet, to be secured by the nut (4) and threaded rod (5).
3. Fit the tail pipes (6) to the fitting and connect the hot and cold supplies. DO NOT OVERTIGHTEN. Soft copper tails can be carefully bent and cut to length to meet supply pipes.
4. Fit the pop up waste, with the flat washer (10) below and the shaped washer (11) above the basin/bidet. It is recommended that a silicon sealant be applied to both sealing faces of washers 10 and 11. The plug height can be set by, adjusting the waste rod (9) and operating rod (7) connecting bracket (8), and the screw (12) in the base of the plug. Friction for the waste mechanism can be adjusted using the waste body cap (13).
5. Fit tap handles. Fitting varies depending on handle. Either disassemble handle and use screw hidden under cap or secure plastic adaptor to valve with screw and then push on handle. **NOTE: - Handles must be bought separately.**
6. Fully open both valves, letting them run for a few minutes to check all joints and connections for leaks.
7. See over the page for aftercare instructions.

MAINTENANCE

If the fitting begins to drip:

1. Isolate water supplies.
2. Disassemble/remove handle, unscrew retaining screw and lift off the handle.
3. Unscrew the valve. Carefully clean seating, rubber washer and/or ceramic disc.
4. Refit the valves, handles and tighten retaining screw. Replace the top of the handle or handle indices.
5. If problem persists contact our helpline quoting the product code.

Please Note: -

In the unlikely event you find a part missing please contact our customer Service Help line on 0844 701 6273 for immediate despatch of part.