



For latest prices and delivery to your door visit MYTub Ltd 0845 303 8383 www.mytub.co.uk

### AFTERCARE INSTRUCTIONS

Your fitting has a high quality finish and should be treated with care to preserve the visible surfaces. All surface finishes will wear if not cleaned correctly, the only safe way to clean your riser rail is to wipe with a soft damp cloth. Stains can be removed using washing up liquid. All bath cleaning powders and liquids will damage the surface of your fitting even the non scratch cleaners.

### GUARANTEE

All products are manufactured to the highest standards and a 5 year guarantee covers any defect in manufacture. As gold and special effect finishes are softer than chromium plate, special care must be taken when cleaning, a 3 year guarantee covers these finishes.

**NOTE: - the 5 year guarantee on the valves is invalidated if damaged by any waterborne debris.**

*In the interests of continuous product development we reserve the right to alter specification as necessary*

### PRODUCT CODE: PM SDIV C

### TELEPHONE HELP LINE! +44 (0) 870 4425553

Bristan Limited  
Birch Coppice Business Park  
Dordon  
Tamworth  
Staffordshire  
B78 1SG  
UK  
Web site: [www.bristan.com](http://www.bristan.com)  
Telephone: +44 (0) 870 4425556  
Facsimile: +44 (0) 870 4425554  
Email: [enquire@bristan.com](mailto:enquire@bristan.com)  
(FI PM SDIV 19/03/04 Rev. D1)

(S)



## Prism Diverter Valve

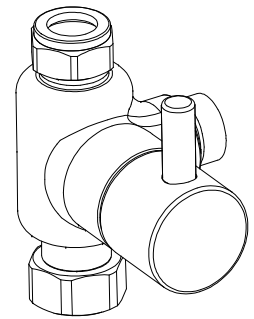

## Fitting Instructions & Contents List

**Please keep these instructions for future reference and request of replacement parts**



## INSTALLATION

The diverter is designed to be fitted onto the G 1/2" male outlet of an exposed shower valve to feed water to a rigid riser or handset and hose.

1. Identify all components, study diagram and check for completeness, particularly before arranging installation.
2. Install the shower valve (not supplied) as directed using the fitting instructions supplied with that product.
3. Connect diverter (1) to shower valve via nut (2) using washer (3).
4. The vertical tube from the rigid riser (not supplied) will connect to the diverter via the compression nut (4) and olive (5) or G 1/2" female nut with a flat washer to seal. (Depending on the rigid riser's specification).
5. Finish fitting rigid riser as per the fitting instructions supplied with that product.
6. Attach hose to diverter using small rubber washers and handset (not supplied).
7. Turn on shower and operate diverter in both positions using the diverter lever (a) to switch between the rigid riser and the handset. Check all joints and connections for leaks.

## MAINTENANCE

**If either fitting begins to drip during operation:**

1. Ensure shower control is in the 'off' position.
2. Unscrew lever (a) loosen grub screw (b), diverter head (c) and unscrew valve.
3. Carefully clean seating, rubber washer.
4. Replace valve and handle then test shower.
5. Contact our helpline if problem persists.

## CONTENTS

- |    |                 |      |
|----|-----------------|------|
| 1. | Diverter        | (x1) |
| 2. | Connecting nut  | (x1) |
| 3. | Washer          | (x1) |
| 4. | Compression nut | (x1) |
| 5. | Olive           | (x1) |

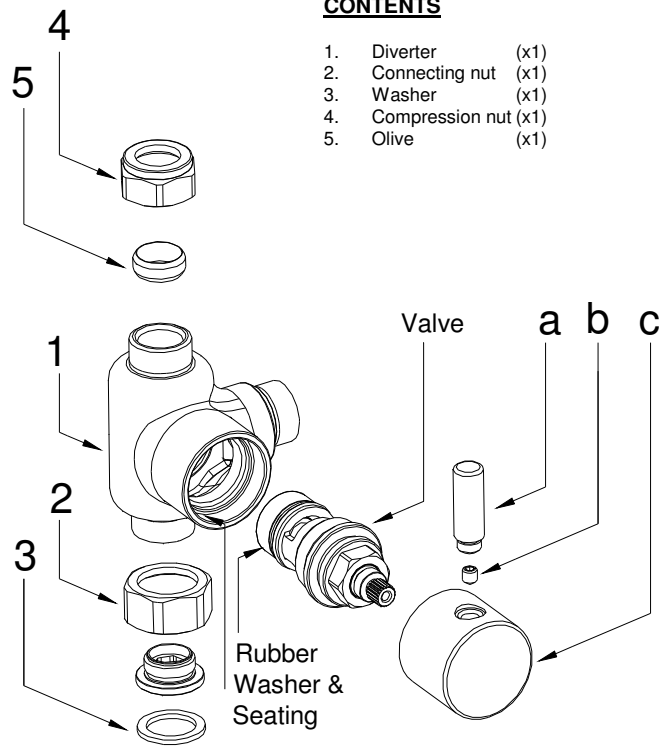

### Please Note:

In the unlikely event you find a part missing please contact our Customer Service Help line on 01827 311345 for immediate dispatch of par