

8. Guarantee & Registration

8.1 Guarantee

All products are manufactured to the highest standards and 5-year guarantee covers any defect in manufacture.

Any part found to be defective during the above guarantee period will be replaced without charge providing that the product has been installed in accordance with our instructions, used as intended and maintained/serviced as recommended.

In the unlikely event that any problems are encountered with this product's performance on installation, you must obtain guidance/authorisation from our Customer Service Department before any remedial action is taken and be able to supply proof and date of purchase.

The guarantee excludes damage caused by accident, misuse or neglect and does not cover the following:

- Those components subject to wear and tear such as 'O' rings and washers etc,
- Damage caused by faulty installation,
- Damage caused by any waterborne debris,
- Damage caused by improper cleaning products,
- Damage caused by the use of non-Bristan parts,
- The product being used for a purpose other than intended.

The company reserves the right, in the event of a claim not covered by the guarantee, to charge the claimant for parts and labour at current rates. This guarantee is given in addition to and does not affect your statutory rights.

In the interests of continuous product development we reserve the right to alter the specification as necessary.

PRODUCT CODE: PANEL101

TELEPHONE HELP LINE! +44 (0)870 442 5553

Bristan Limited
Lagrange
Lichfield Road Industrial Estate
Tamworth
Staffordshire
B79 7XD
UK

A MASCO COMPANY

Web Site: www.bristan.com
Telephone: +44 (0)870 442 5556
Facsimile: +44 (0)870 442 5554
Email: enquire@bristan.com

(FI PANEL101)

(Rev. D1)

(SX)

Thermostatic Shower Panel (Panel101)

Fitting Instructions & Contents List



Before starting any installation project, consider "safety" first. Look for the "safety note" sign and read the safety advice.

Please keep these instructions for future reference and request of replacement parts.

Contents

Section	Description	Page No:
1.	Introduction	2
2.	Specification	2
3.	Pack Contents Checklist	3
4.	Installation	3
5.	Operation & Setting	4
6.	Fault Diagnosis	4
7.	Cleaning & Maintenance	5
8.	Guarantee	8

1. Introduction

Your Bristan thermostatic shower fitting incorporates a wax capsule thermostat to ensure constant showering temperatures. This valve has been designed and tested to comply with BS EN 1287:1999 & BS EN1111:1999 and manufactured to the highest quality standards. These installation instructions are for your guidance to a safe and successful installation, and should be left with the user after installation.

2. Specification

Inlet Connections: 15 mm compression
 Water Pressures: Min: 1.5 bar – Max: 8 bar – Maximum recommended imbalance between hot & cold pressures should not exceed a ratio of 5:1

Maximum Outlet Temp: Factory Set to 38°C (can be re-set to suit site conditions).

Hot & Cold Supply Temperatures

Minimum Recommended Hot Supply: 60°C
 Maximum Hot Supply: 80°C
 Maximum cold Supply: 25°C

Note: the inlet hot water temperature must be at least 10°C above required blend temperature

Diagram 2

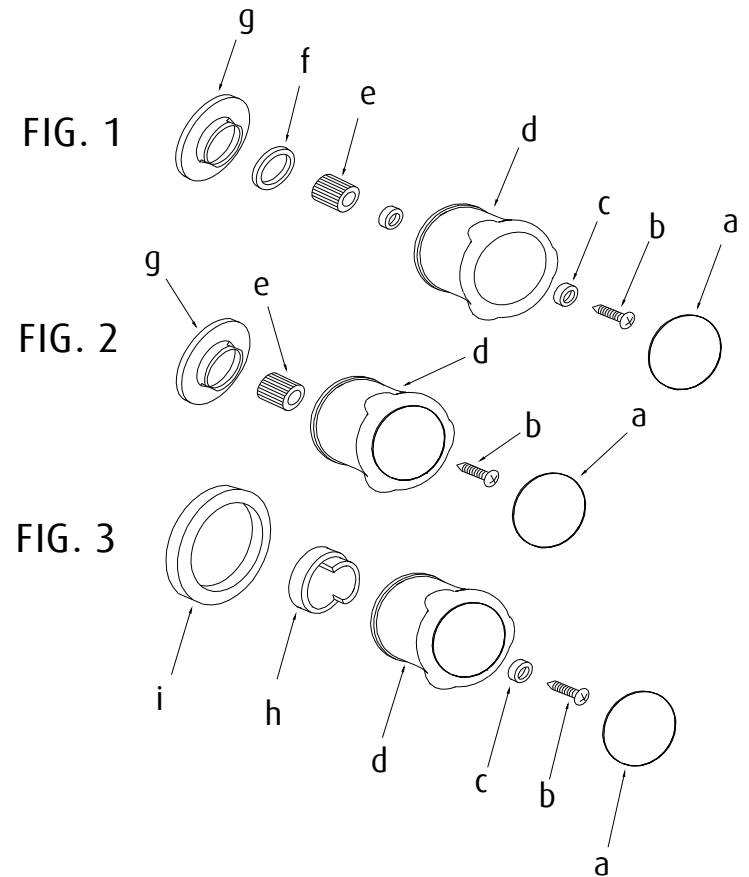
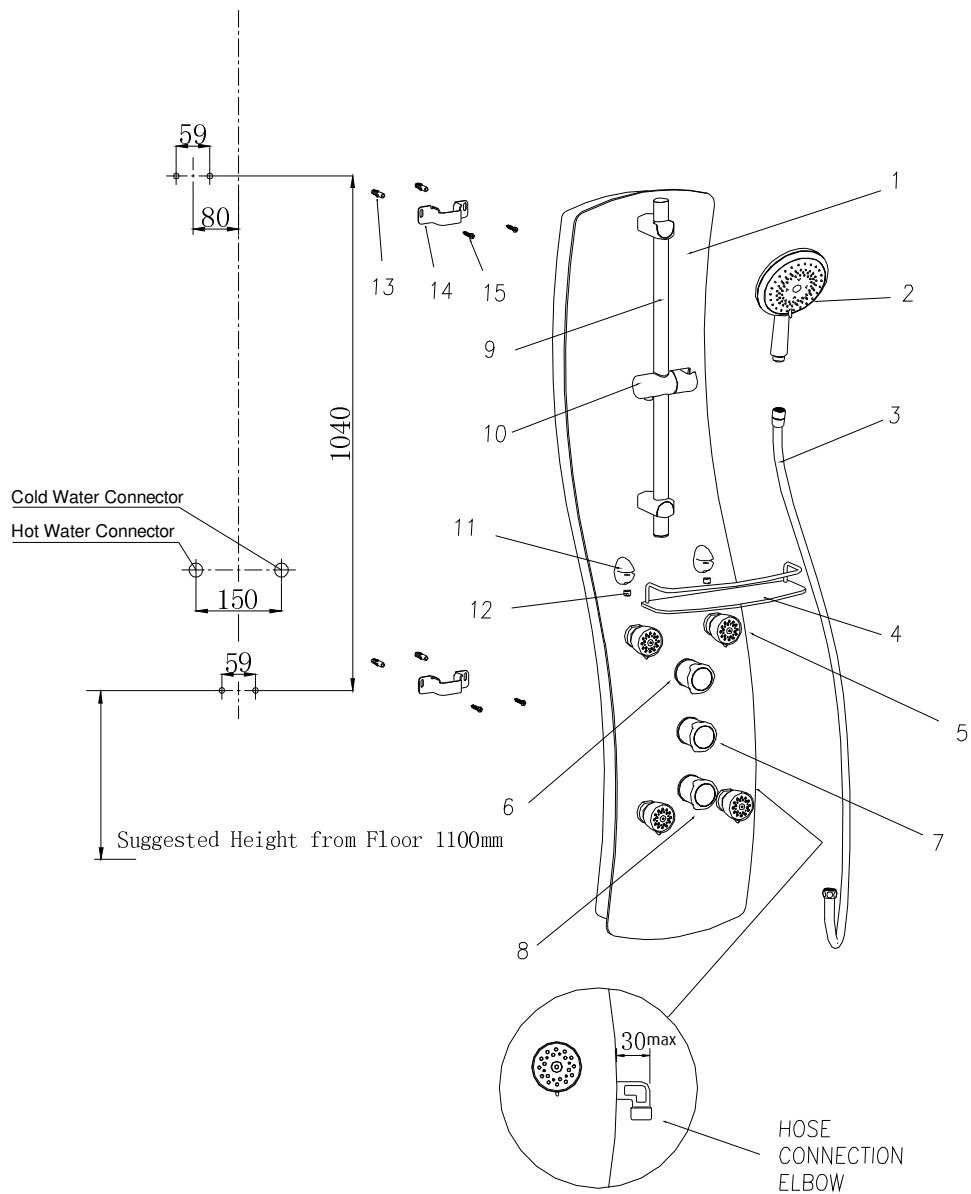

Diagram 1



3. Pack Contents Checklist

1. Shower Panel Assembly	(x1)	5. Wall Plugs	(x4)
2. Handset	(x1)	6. Wall Brackets	(x2)
3. Hose	(x1)	7. Bracket Screw	(x4)
4. Shelf	(x1)		

4. Installation
(See Diagram 1, Page 6)



Prior to drilling into walls, check there are no hidden electrical wires, cables or water supply pipes with the aid of an electronic detector. If you use power tools do not forget:

- Wear eye protection
- Unplug equipment after use

- 4.1** Identify all components and check for completeness, particularly before arranging fitting.
- 4.2** This unit should be installed in compliance with Water Regulations. For further details contact your Local Water Authority.
- 4.3** This unit is suitable for use with the following systems:
- Gravity Fed Hot & Cold (Equal Pressure)
 - Gravity Fed Hot & Mains Cold (Differential Pressure - Max Ratio 5:1)
 - Unvented Systems
 - Gas Combination Boiler
 - Pumped System
- 4.4** Mark out positions for plug (13) and screw (15) holes where bracket (14) is to be fixed. This must be referenced with the bracket positions on the rear of the shower panel (1) itself.
- 4.5** Once brackets are attached to the wall, the shower panel may then be fitted by placing brackets on rear of panel to those fixed on wall.
- 4.6** Connect the flexible pipes from rear of panel to the appropriate water supplies, hot on the left and cold on the right, with the outlet on the top. Before connecting the mixer, water should be flushed through the system to remove all debris.
- 4.7** Fit the hose (3) to the handset (2) using the small sealing washers provided and then connect to the hose outlet (positioned at the side of the panel).

5. Operation & Setting

5.1 Operation

There are 3 control handles on this valve. To control the flow turn the handle (7) anti-clockwise to turn on and increase the flow, and clockwise to decrease and turn off. On the temperature control (8) a numbered dial indicates the direction for hot and cold flow. Turn anti-clockwise for hot and clockwise for cold. If in operation an increase in temperature above the factory set temperature is required, simply depress the button on the temperature handle when it reaches the stop and continue to turn the handle anti-clockwise until the desired temperature is found. Control handle (6) is used to select optional modes from handset (2) to body jets (5).

5.2 Setting

The temperature stop is factory set at 38°C. This can however be adjusted for site conditions or personal preference by removing the screw cover from blending valve (8), unscrewing the valve screw and removing the temperature control spindle (black plastic ring). Turn the control spindle on the temperature valve in the required direction to increase or decrease the temperature. Replace the handle so that the stop is in the maximum position. Screw the handle back onto the valve and replace the cover.

6. Fault Diagnosis

If your unit fails to function correctly, the following should be checked:

6.1 Check that the hot and cold connections are the correct way around. Hot on the left and cold on the right (when viewed from the front).

6.2 Ensure that the hot water temperature is adequate; the recommended minimum temperature is 60°C. The hot water temperature should be at least 10°C higher than the blend temperature to ensure that the safety shut off will work.

7. Cleaning & Maintenance

7.1 Cleaning

Your fitting has a high quality finish and should be treated with care to preserve the visible surfaces.

All surface finishes will wear if not cleaned correctly. The only safe way to clean your unit is to wipe it with a soft damp cloth. Stains can be removed using washing up liquid. All bath cleaning powders and liquids will damage the surface of your unit, even non-scratch cleaners.

7.2 Maintenance (See figures 1, 2 and 3 on page 7)

We advise that the unit be regularly serviced, particularly in hard water areas. It is also important to clean the handset regularly in hard water areas to maintain an even spray/flow of water.

To clean valve, the water supplies must be turned off. Should the shower need to be dismantled for cartridge maintenance then the procedure is:

7.2.1 Prise out the screw cover (a) on handle (d), loosen screw (b) with washer (c) and remove handle shown in figure 3.

7.2.2 Remove the black plastic ring (h), taking note of its position, unscrew the thermostatic cartridge and clean with water to remove dirt.

7.2.3 Before reassembling the cartridge, clean its housing with a wet cloth and grease the O-rings on the cartridge with a suitable silicon grease.

7.2.4 Reassemble the cartridge and replace the black plastic ring (h) in its original position.

7.2.5 Repeat the cleaning operation for the diverter (6), (figure 1) and stop cock (7), (figure 2) if necessary by again, prising out the screw cover, loosening the screw and then removing the handle.

7.2.6 Shrouds (i) and locknuts (g) should be removed to gain access to valve.

7.2.7 Clean washer and its seat inside the shower body and reverse procedure to reassemble.

7.2.8 Turn on the water supply and, if necessary, reset the temperature. (See 5.2).

7.2.9 Re-fit the handles and screw in position.