

AFTERCARE INSTRUCTIONS

Your fitting has a high quality finish and should be treated with care to preserve the visible surfaces. All surface finishes will wear if not cleaned correctly, the only safe way to clean your product is to wipe with a soft damp cloth. Stains can be removed using washing up liquid. All bath cleaning powders and liquids will damage the surface of your fitting even the non scratch cleaners.

GUARANTEE

All products are manufactured to the highest standards and a 5 year guarantee covers any defect in manufacture.

NOTE - the 5 year guarantee on the valves is invalidated if damaged by any waterborne debris.

In the interests of continuous product development we reserve the right to alter specification as necessary

PRODUCT CODE: Z LUX 1/2 C

TELEPHONE HELP LINE! +44 (0) 870 4425553

Bristan Ltd
Lagrange
Lichfield Road Industrial Estate
Tamworth
Staffordshire
B79 7XD

Web- www.bristan.com
Tel- +44 (0) 870 4425556
Fax- +44 (0) 870 4425554
Email- enquire@bristan.com

(FIZ LUX 1/2)

(D1)

(AJ)

BRISTAN
showers taps accessories

Luxury Self Closing Basin Tap (Z LUX 1/2 C)

Fitting Instructions & Contents List

Please keep these instructions for future reference and the request of replacement parts

WATER SUPPLY REQUIREMENTS

When installed within the United Kingdom it is important to ensure that your taps and mixers are installed strictly in accordance with the regulations and / or Bylaws relevant to the local area in which they are to be installed, and good plumbing practice. The following Regulations or Bylaws apply to the United Kingdom:

- England & Wales - The Water Supply (Water Fittings) Regulations, current.
- Scotland - Water Bylaws, Scotland, current.
- Northern Ireland - Water Regulations (Department Of The Environment) Northern Ireland

If in any doubt we would recommend that you take advice from your local water undertaker or authority. Useful contacts are:

The Secretary of the Water Regulations Committee at WRC. Tel 01495 248454
The Institute of Plumbing. Tel 01708 472791

For the guarantee to be valid, the unit must be installed by a competent person.

The Regulations / Bylaws are designed to prevent waste, misuse, undue consumption and contamination of public water supplies in domestic, commercial and public plumbing installations.

It may be necessary to incorporate backflow and cross contamination prevention devices in the supply pipes, depending on the installation, type of product used, and the fluid category.

OPERATING PRESSURES

Minimum working pressure:- 0.1 bar
Maximum working pressure:- 4 bar

INSTALLATION ADVICE

- Before commencing installation identify all components and check that the product is complete and in good condition. Check all connections are fully tightened and that tap valves are tight in the body.
- All supply pipework should be thoroughly flushed before connecting the taps and mixers to remove any debris in the pipework. Waterborne debris will not only damage internal parts, this will also invalidate your guarantee.
- Check that the air gap (spill over level) is in accordance with the relevant Regulations or Bylaws.
- Ensure that the hot and cold supply pipework (where necessary) is on the correct side for the connection to the taps. Generally hot is on the left and cold on the right when viewed from the front (mixers only).
- Check water pressures to ensure sufficient pressure is available.
- Check the water supplies and water heaters are turned off before commencing installation.
- After installation check that there are no leaks in the pipework or connections. Check that all connections are adequately tightened.
- Earth any new pipework. If in doubt consult an expert.

SURFACE CLEANING



For surface cleaning of the mixer use water and soap only, and dry with soft cloth. Any other cleaning product may damage the surface.

NON-COMPLIANCE WITH THE INSTRUCTIONS WILL RENDER THE GUARANTEE INVALID

INTRODUCTION

Designed to save water and energy costs, this flow control tap is easy to operate, even by users with reduced mobility. These taps are ideal for a cold inlet or for fitting with a thermostatic blending valve for temperature controlled safety. The following information is useful:

- * Water saving hand-washing
- * Automatic shut off for water saving
- * Replaces conventional tap
- * Simple push action activates the tap for 9 - 14 seconds
- * Delivery of hot safe water when fitted with thermostatic blending valve
- * Non concussive action prevents water hammer
- * Vandal resistant
- * Ideal for unsupervised washrooms
- * Suitable for use in commercial premises, institutions and public access washrooms

INSTALLATION

IMPORTANT: Flush pipework carefully for a long while before fitting the tap. Do not allow dirt, metal particles, shavings to contaminate the supply pipes. *Ensure ALL parts are in the box.*

1. Isolate water supply.
2. Ensure the plug and cap are removed.
3. Fix body(4) into position using plinth (5), indices/washer (6) above the basin and backnut (7) below the basin.
4. Check the cartridge assembly and flow straightner are securely fastened into the body.
5. Connect water supplies.

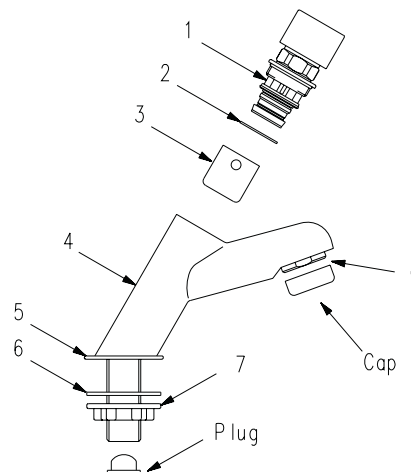

CONTENTS

- | | |
|-----------------------|------|
| 1. Cartridge Assembly | (x1) |
| 2. Cup Washer | (x1) |
| 3. Cup | (x1) |
| 4. Tap Body | (x1) |
| 5. Plinth | (x1) |
| 6. Indices/washer | (x1) |
| 7. Backnut | (x1) |
| 8. Aerator | (x1) |