

Malleable Iron

Options:



Galvanised



Black

241 Union PN25

FLAT SEAT

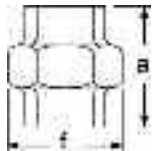

FITTING SIZE	DIMENSIONS (mm)		WEIGHT (kg) per 100 pieces
	a	f	
1/2	49	42	20.44
3/4	53	49	30.39
1	58	57	41.22

299 Gasket for Fig. 241

FITTING SIZE	WEIGHT (kg) per 100 pieces
1/2	-
3/4	-
1	-

(compressed non-asbestos fibre)

256 Union PN25

SPHERICAL SEAT - Iron to Iron

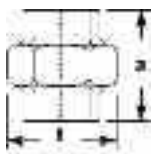

FITTING SIZE	DIMENSIONS (mm)		WEIGHT (kg) per 100 pieces
	a	f	
1/4	42	32	11.14
3/8	45	36	13.75
1/2	49	42	20.70
3/4	53	49	30.08
1	58	57	40.75
1 1/4	64	68	60.67
1 1/2	68	76	78.49
2	75	92	119.89
2 1/2	84	111	187.05
3	92	125	248.33
4	107	155	426.52

257 Male & Female Union PN25

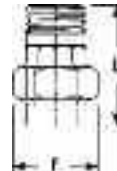

FITTING SIZE	DIMENSIONS (mm)			WEIGHT (kg) per 100 pieces
	b	a	f	
1/4	57	32	†	11.95
3/8	61	36	†	16.07
1/2	68	56	42	25.85
3/4	74	74	49	36.77
1	82	57	57	50.63
1 1/4	91	68	†	74.26
1 1/2	95	76	†	99.95
2	104	92	†	147.70
2 1/2	116	111	†	232.78
3	131	125	†	324.66

261 Elbow Union PN25

SPHERICAL SEAT - Iron to Iron

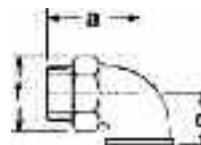

FITTING SIZE	DIMENSIONS (mm)			WEIGHT (kg) per 100 pieces
	a	c	f	
1/2	56	28	42	25.72
3/4	64	33	49	37.31
1	72	38	57	54.38

Every effort has been made to ensure that the information contained in this publication is accurate at the time of publishing. Crane Ltd assumes no responsibility or liability for typographical errors or omissions or for any misinterpretation of the information within the publication and reserves the right to change without notice.